

ROLGORDIJNEN

b & m



b & m

INHOUDSTAFEL

1. BASISKEUZES

1.1 STOFKEUZE	P. 5
1.2 AFROLMOGELIJKHEDEN	P. 6
1.3 BEDIENINGSKANT	P. 7
1.4 KETTINGGEWICHTEN	P. 7
1.5 KETTINGKLEUR	P. 8
1.6 KETTINGLENGTE	P. 8
1.7 ONDERLAT	P. 9
1.8 CHILD SAFETY	P. 10

2. REN

2.1 ALGEMENE INFO	P. 13
2.2 STEUNTJES	P. 14
2.3 BEDIENING	P. 19
2.4 OPMETEN	P. 22
2.5 TECHNISCH OVERZICHT	P. 23

3. BIG

3.1 ALGEMENE INFO	P. 49
3.2 STEUNTJES	P. 50
3.3 BEDIENING	P. 53
3.4 OPMETEN	P. 54
3.5 TECHNISCH OVERZICHT	P. 55

4. DUO

4.1 ALGEMENE INFO	P. 73
4.2 STEUNTJES	P. 74
4.3 BEDIENING	P. 79
4.4 OPMETEN	P. 82
4.5 TECHNISCH OVERZICHT	P. 83

BASISKEUZES

b & m



1. BASISKEUZES

1.1 STOFKEUZE

1. SCREEN

Screenstoffen bestaan in vijf verschillende gradaties van lichtdoorlaatbaarheid. Ze zijn ook afwasbaar.

2. PLAIN

Unistoffen, lichtdoorlatend.

3. TRANSPARANT

Doorzichtiger dan plain, meer contact met buiten.

4. BLACK-OUT

Deze stoffen blokkeren het licht: ze zorgen ervoor dat een kamer verduisterd wordt.

Ze zijn ideaal voor in een slaapkamer.

5. DUO

Duo-stoffen bestaan uit banen transparante stof, afgewisseld met banen die minder licht doorlaten.

Door twee van deze stoffen achter elkaar te hangen, kan het licht al dan niet doorgelaten worden.

Duo-rolgordijnen komen steeds in een box.

6. PRINTS

Dessins van uni-stoffen kunnen geprint worden op verschillende ondergronden.

1.2 AFROLMOGELIJKHEDEN

Er zijn twee mogelijkheden om uw gordijn af te rollen.

NORMAAL

Normaal betekent dat uw rolgordijn afrolt aan de raamzijde. Hierbij is de rol bovenaan ook zichtbaar.

Voordeel:

- Grotere lichtafdekking
- Plaatswinst op de vensterbank

Nadeel:

- De achterkant is zichtbaar bij het oprollen. Dit is vooral van belang bij black-out stoffen.



CONTRA

Bij contra hangt het gordijn voor de rol waardoor de spatie tussen het raam en het rolgordijn groter is.

Voordeel:

- Een grotere isolatiespouw bij raamkruk/klink
- Makkelijker om hoeken aan elkaar te zetten

! Contra rollend is niet mogelijk bij duo rolgordijnen

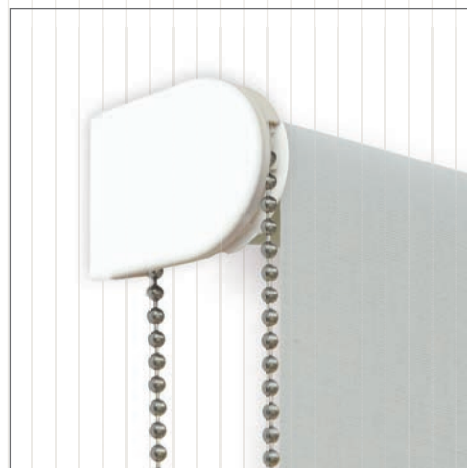

KOOF

Half-open / gesloten (zie p. 35)

Een rolgordijn dat in een koof zit kan enkel normaal worden afgerold. Hier kan u de keuze contra niet maken.



BASISKEUZES



Van de binnenkant bekeken.

1.3 BEDIENINGSKANT



LINKS

De ketting bevindt zich aan de linkerkant.



RECHTS

De ketting bevindt zich aan de rechterkant.

1.4 KETTINGGEWICHTEN

KUNSTSTOF = standaard



Wit

Grijs

Zwart

Afmetingen: a = 66 mm, b = 45 mm

METAAL = meerpijs



Nikkel

Brons

Nikkel

Brons

RECHTHOEKIG

ROND

Afmetingen: a = 78 mm, b = 70 mm

1.5 KETTINGKLEUR

Het rolgordijn wordt altijd bediend met een ketting.

U kan een kettingkleur kiezen.

Standaard kiezen wij de kleur die het beste bij de kleur van het rolgordijn past.

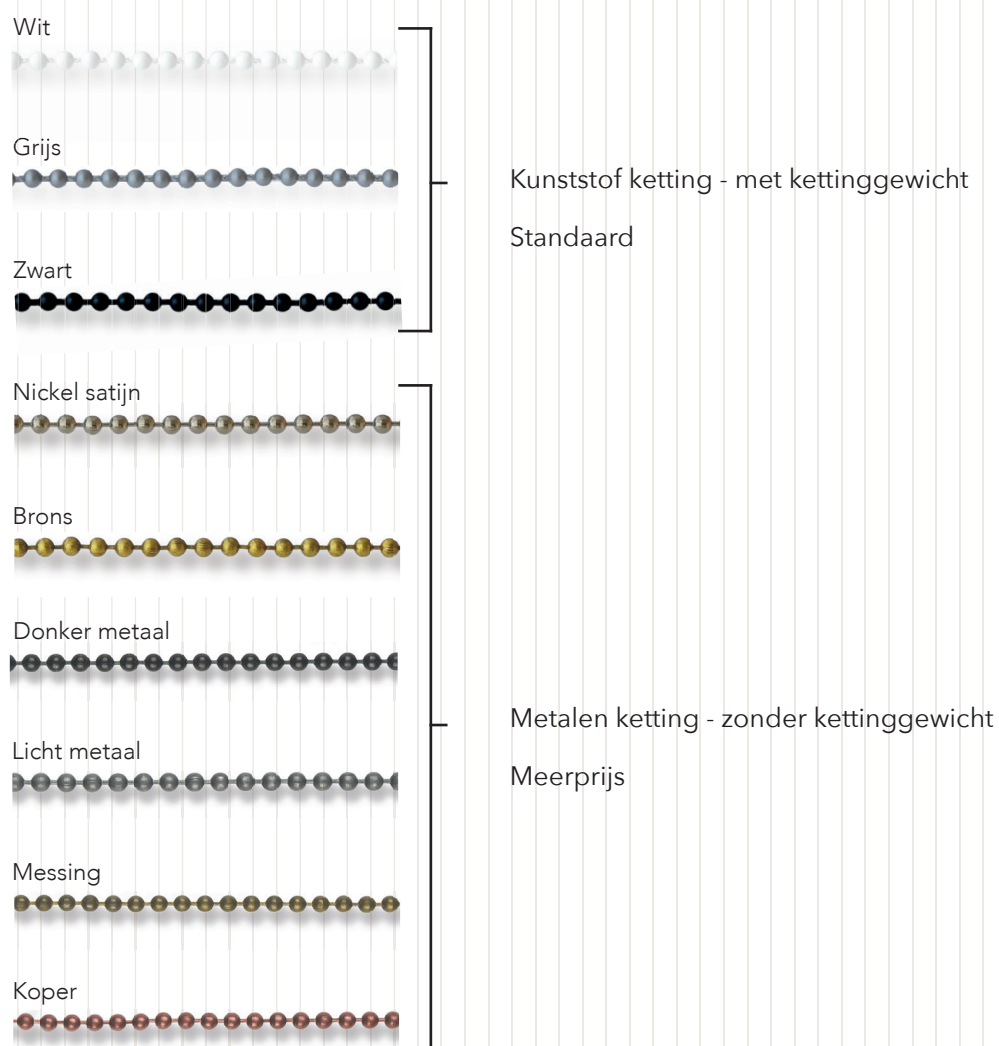

1.6 KETTINGLENGTE

Bepaal hoe lang uw ketting moet zijn.

Lees p. 10 i.v.m. 'child safety'.

Tot een breedte van 3,40 meter

Enkel voor DUO

Enkel voor BIG

Type K	Type L	Type C	Type C 25	Type I2	Type I	Type M	Type H	Type D	Type O	Type E	Type G	Type M2	Type F 1	Type J30	Type W50
 Standaard tot 3m	 Standaard tot 3m	 Standaard tot 3m	 Standaard tot 3m	 Standaard tot 3m	 Standaard tot 3m	 Standaard tot 3m	 Standaard tot 3m	 Standaard tot 3m	 Standaard tot 3m	 Standaard tot 3m	 Standaard tot 3m	 Standaard tot 3m	 Standaard tot 3m	 Standaard tot 3m	 Standaard tot 3m

■ Geanodiseerd aluminium

Niet voor screens of dickere stoffen.

Houten onderlat - kleuren te kiezen uit de 5 standaardkleuren op pagina 15, of 'any color you want'.

1.8 CHILD SAFETY

Veiligheidselementen

Kettingadaptor met de mogelijkheid om los te koppelen. Kleur: wit.



Balgekoppelde ketting met de mogelijkheid om los te koppelen. Kleur: transparant.

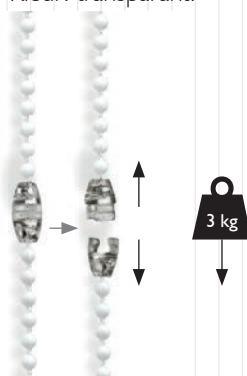

Kettinghouder om de ketting vast te maken aan de muur.

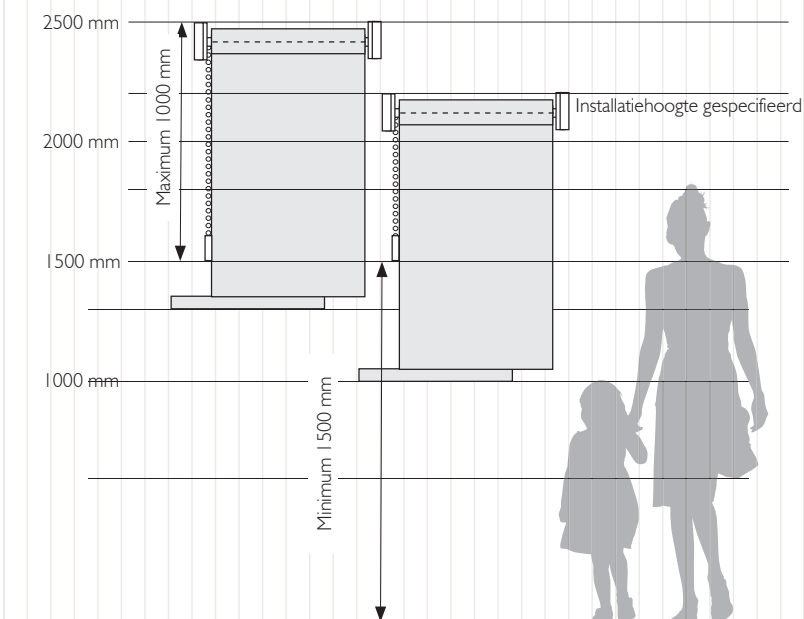

EN 13120

De Europese standaard eist dat raamdecoratieproducten zo ontworpen zijn dat kinderen zich hier niet aan kunnen kwetsen. In de praktijk wil dit zeggen dat de lengte van de bedieningstouwjes en/of ketting, alsook de bevestiging, onderworpen is aan de wetgeving hierover. Dit zorgt ervoor dat de kans tot verhänging bij kinderen tussen 0-42 maanden wordt gereduceerd tot nul. Bmfabrics levert bij elke bestelling van rolgordijnen een kettinghouder die bevestigd wordt aan de muur.

Als op het order de kettinglengte niet aangegeven is, zal Bmfabrics een kettinglengte meeleveren van maximum 1 meter. Wij vragen dus steeds om de kettinglengte op te geven, dit om misverstanden te vermijden.

!

WAARSCHUWING



Jonge kinderen kunnen verstrikt geraken in de lus van de trekkoorden, kettingen, banden en koorden waarmee de raambekleding bediend wordt. Ook kunnen ze koorden om hun keel wikkelen. Hou om wurging en verstikking te voorkomen de koorden buiten bereik van jonge kinderen. Verwijder bedden, wiegen en ander meubilair uit de buurt van raambekledingkoorden. Knoop de koorden niet aan elkaar. Zorg dat de koorden niet verstrengeld raken of een lus vormen.



2.REN

2.1 ALGEMENE INFO

25 CM LENGTE



340 CM LENGTE

BESCHIKBAAR IN BUIS MET DIAMETER 32, 40, 47 EN 54 MM

HOU STEEDS REKENING MET DE 1/3 VERHOUDING, ZIE P. 40

STEUNTJES: STANDAARD, HOUT, DESIGN EN MONTAGEPROFIEL, CASSETTESYSTEEM

BOX ROUND: 68/86

BOX SQUARE: 86

ZIJGELEIDER: ENKEL 86

BOX 68 TOT 280 CM

ZONDER BOX TOT 340 CM

MOTOR ENKEL VANAF DIAMETER 40 MM

MOTOR 230 V VOOR GROTERE DIAMETERS

2.2 STEUNTJES

2.2.1 STEUNTJES STANDAARD



SMALL

Steuntje: 32 mm

Buis: 32 mm

+ any color you want



MEDIUM

Steuntje: 40 mm

Buis: 40 mm

+ any color you want



LARGE

Steuntje: 47 mm

Buis: 47 & 54 mm

+ any color you want

2.2.2 STEUNTJES HOUT

De houten steuntjes zijn beschikbaar in rechte en ronde afwerking. Niet beschikbaar in buisdiameter 32 mm.

SMALL

Afmetingen: buis 40 mm

5 standaardkleuren voor steuntjes,
any color you want mogelijk mits meerprijs.

MEDIUM/LARGE

Afmetingen: buis 47 en 54 mm

5 standaardkleuren voor steuntjes,
any color you want mogelijk mits meerprijs.



* De houten bovenlat is beschikbaar voor alle REN-systemen zonder box.



2.2.3 STEUNTJES DESIGN



SMALL

Afmetingen:

Enkel beschikbaar in buisdiameter 28 mm.

Afhankelijk van de stof, max. breedte 150 cm tot 180 cm.



2.2.4 MONTAGEPROFIEL*/**

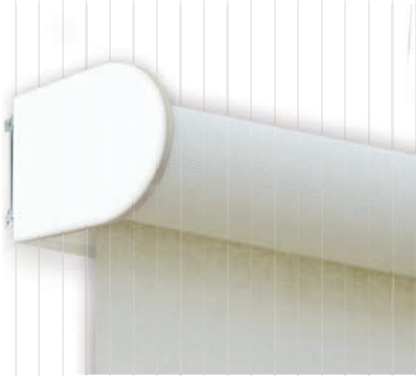

Afmetingen: enkel bij buisdiameter 40 en 47 mm.

2.2.5 KOVEN/BOX



HALF-OPEN BOX ROUND

Afmetingen: box 68 tot 280 cm lengte.



GESLOTEN BOX ROUND

Afmetingen: box 86 tot 340 cm lengte.

* Voor de afmetingen verwijzen we graag naar de technische tekeningen.

** Maximale breedte is steeds afhankelijk van de gekozen stof en de systeemhoogte.

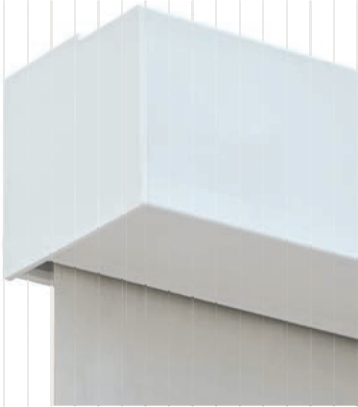

GESLOTEN BOX SQUARE

Afmetingen: box 86 tot 340 cm lengte.

2.2.6 CASSETTE REN

REN N DARK */**

VERDUISTEREND CASSETTE SYSTEEM MET NOPJES



REN N DARK 86 ROUND

* Voor de afmetingen verwijzen we graag naar de technische tekeningen.







** Maximale breedte is steeds afhankelijk van de gekozen stof en de systeemhoogte.

2.2.7 ZIJGELEIDING

Bij zijgeleiding is het niet mogelijk om metalen steuntjes te gebruiken.
 Het is ook niet mogelijk de accessoires te verven.
 Zijgeleiding is niet mogelijk voor contrarollende systemen.

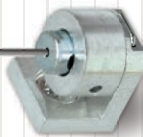
Onderlat b-vl



	Basis - muur	15 × 19 × 13 mm
	Basis - vloer	14 × 6 × 22 mm
	Exclusief - muur	16 × 16 × 21 mm
	Exclusief - muur	Voor montageprofiel 16 × 16 × 32 mm
	Exclusief - vloer	16 × 16 × 21 mm
	Raambevestiging	19 × 26 × 40 mm

GELEIDING

2.3 BEDIENING

2.3.1 MANUELE BEDIENING

KETTINGBEDIEND



Zoals in de basiskeuzes besproken, kan je de keuze maken om het systeem manueel te bedienen.

Dit is steeds met een ketting, waarmee je het systeem op- en neerlaat.

2.3.2 ELEKTRISCHE BEDIENING

OP BATTERIJ 12 V - enkel bij buisdiameter 40 mm

A Bmfabrics-batterij = interne batterij - komt standaard met oplaadbare batterij

S Somfy-batterij = externe batterij - oplaadbare of niet oplaadbare batterijen

Lengte van de batterij: 8 stuks = 45 centimeter , 10 stuks = 55 centimeter

BEDRADE SYSTEMEN

Voeding	Bediening
230 V A Bm-motor	- Draadloze BM-afstandsbediening - Schakelaar/domotica
230 V S Somfy-motor	- Telis- & Modulis-afstandsbediening - Schakelaar/domotica

Al onze elektrische systemen hebben een stille motor.

DRAADLOZE BEDIENING

Het systeem kan draadloos bediend worden door de afstandsbediening van Bmfabrics of van Somfy.
Voor 12 V- en 230 V-systemen: vraag naar onze andere opties.



BM-standaard
1 of meerdere kanalen



Somfy Telis
1 kanaal



Somfy Modulis
1 of meerdere kanalen



Somfy-schakelaar
1 kanaal

2.3.3 GROEPEREN*

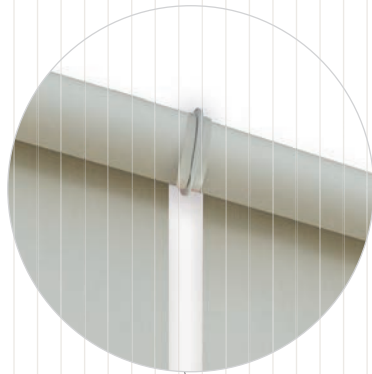

- Om 2 of 3 systemen te groeperen
- 1 aandrijving voor alle gegroepede systemen
- Het op- en neergaan van de rolgordijnen gebeurt tegelijk
- Max. 3 systemen aansluiten op 1 motor

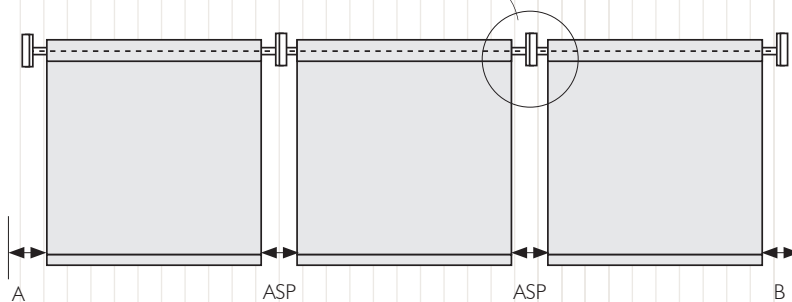

A
= afhankelijk van het
type van systeem

* **Opgelet:** om meerdere motorische systemen te koppelen en met één bediening aan te sturen, dient men altijd een relais te gebruiken.

REN

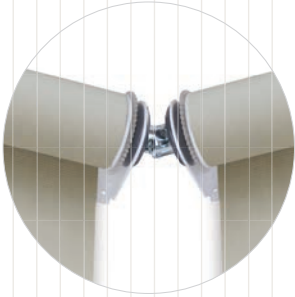

Groepering van een systeem onder een hoek van 0 - 45° zonder box.
Enkel voor REN 47

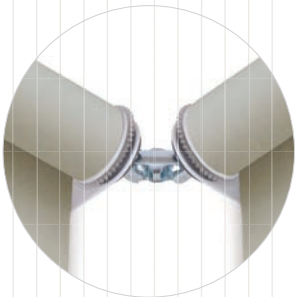

Groepering van een systeem onder een hoek van 0 - 90° zonder box.
Enkel voor REN 47

Groeperen van een groep met een box REN 86R - enkel voor REN 86S.

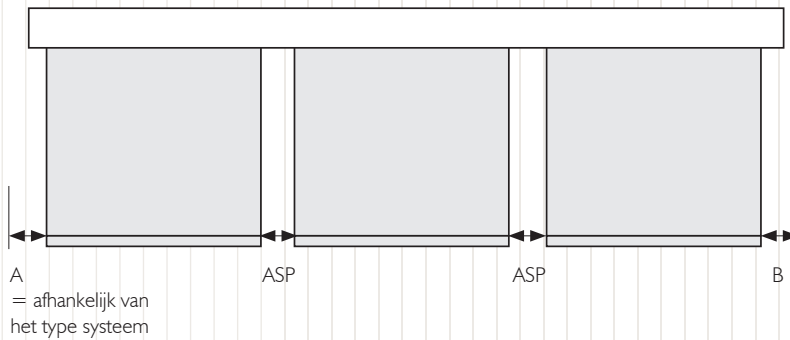

2.4 OPMETEN

Spannende breedte - gewilde speling: wij raden een minimum van 1 cm aan.

! Zorgenvrij: we hebben ook een plaatsingsdienst.

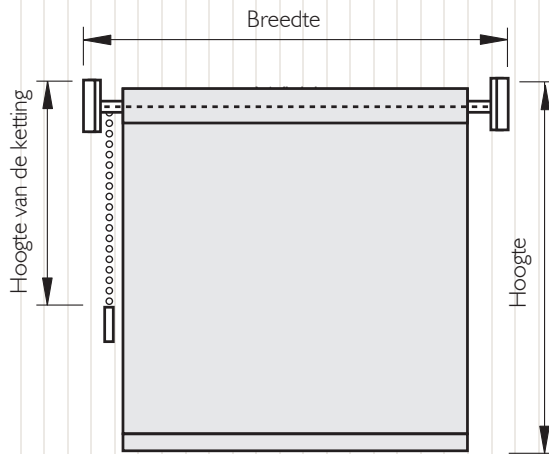

Muurbevestiging

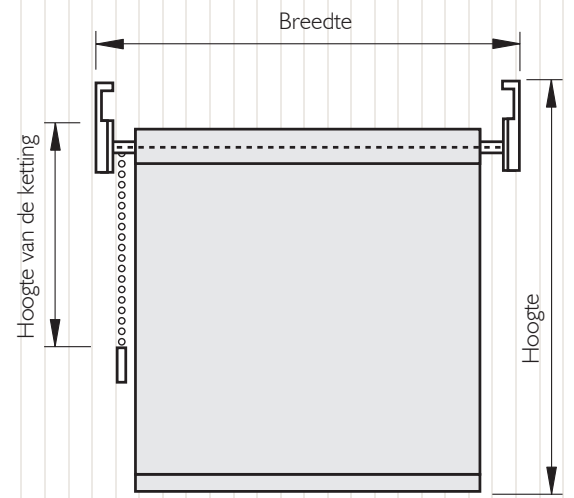

Plafondbevestiging

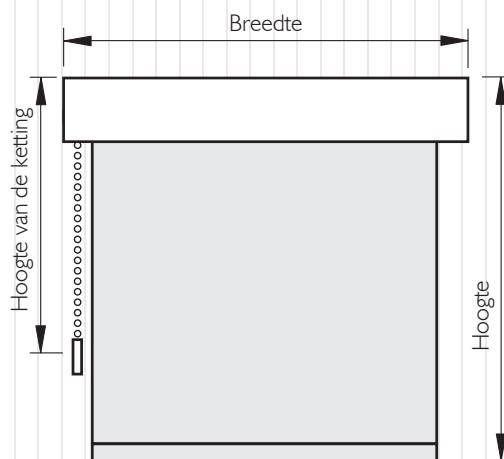

Box

!

Indien de breedte van het systeem $1/3$ smaller is dan de hoogte, kunnen we geen perfecte werking garanderen.

Als de bevestigingskeuze niet gespecificeerd is, kiest Bmfabrics standaard muurbevestiging.

We reduceren de maximum breedte met 20-30 cm voor zware stoffen en stoffen die krimpen.

2.5 TECHNISCH OVERZICHT



REN 32

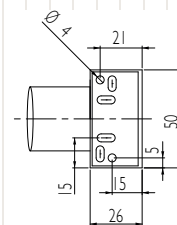
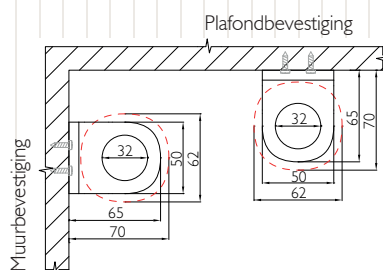
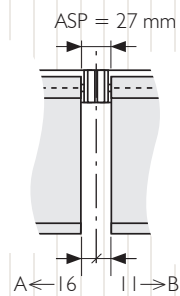
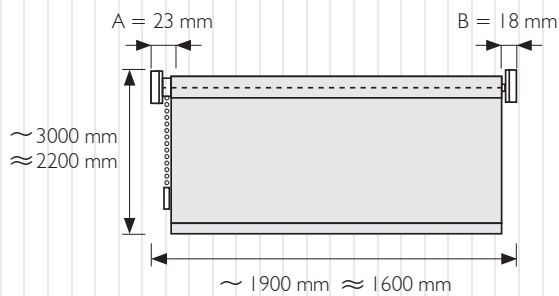

REN 32 design

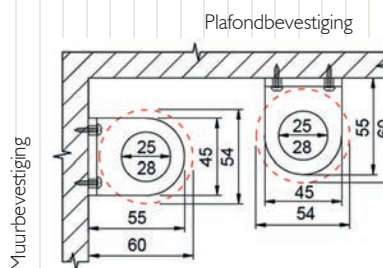
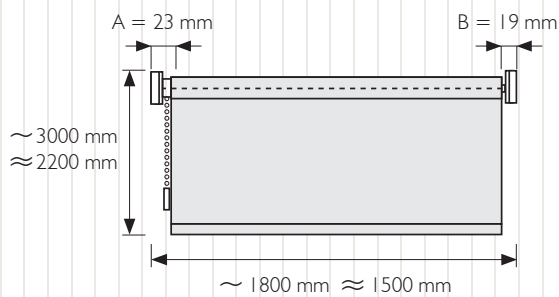

REN - TECHNISCH OVERZICHT

b & m

~ Lichte stof
 ≈ Zware stof

De categorie waarin de stoffen worden ingedeeld kan u in de prijslijst terugvinden.



REN 40

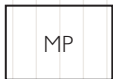
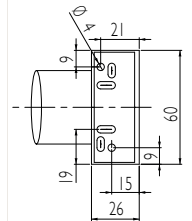
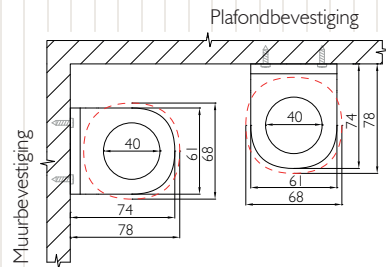
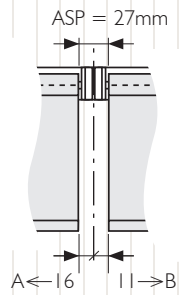
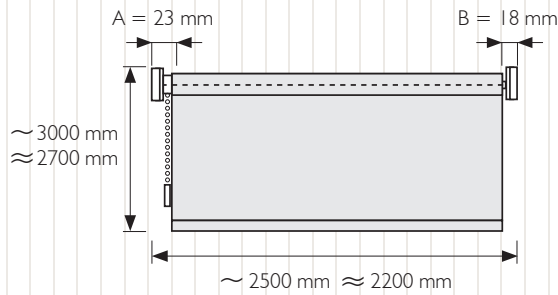

REN 40

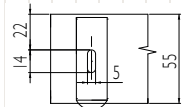
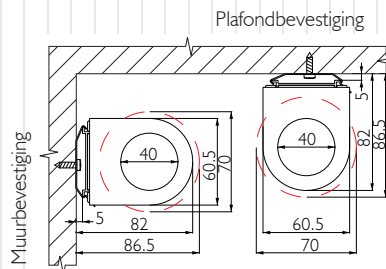
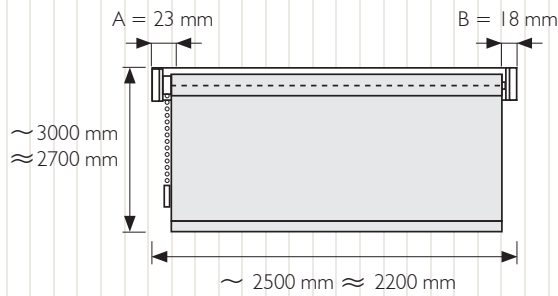

REN - TECHNISCH OVERZICHT

REN 40

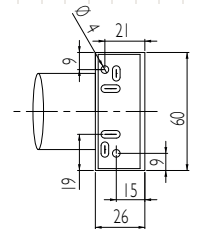
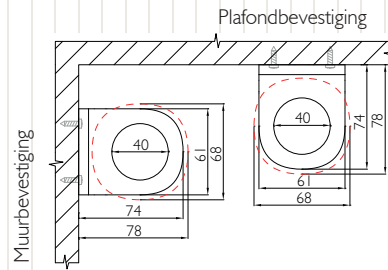
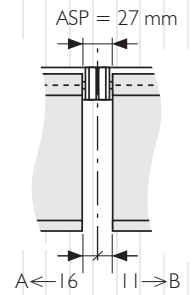
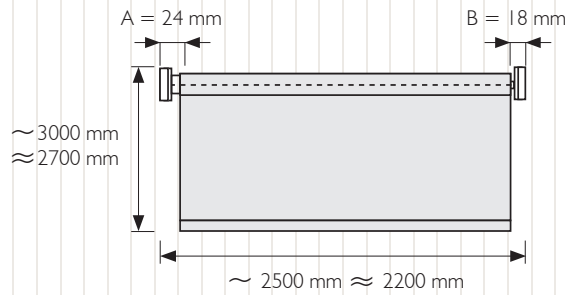
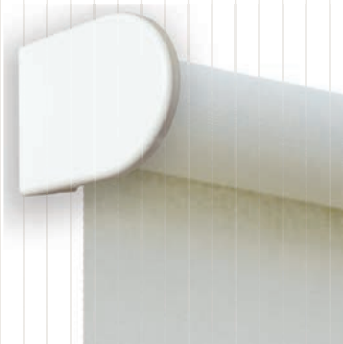
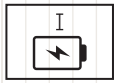

REN 40

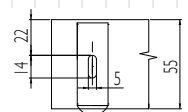
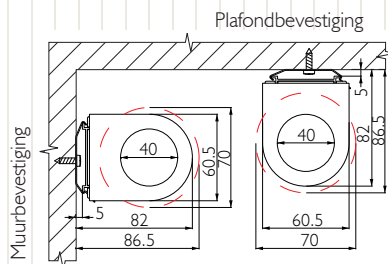
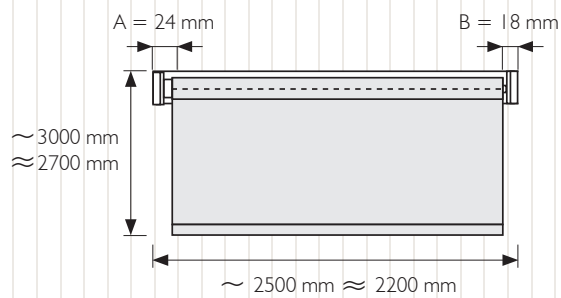
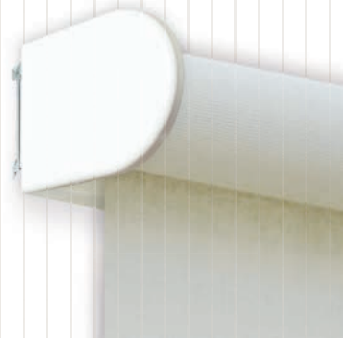
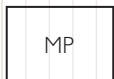
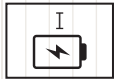

REN - TECHNISCH OVERZICHT



~ Lichte stof
 ~ Zware stof

De categorie waarin de stoffen worden ingedeeld kan u in de prijslijst terugvinden.

 **REN 40**

 RTS

 S battery

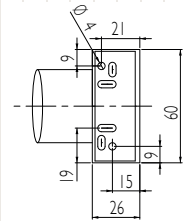
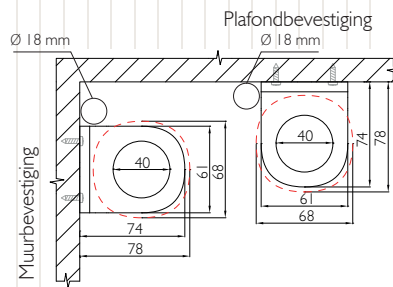
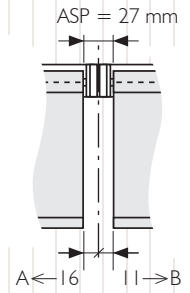
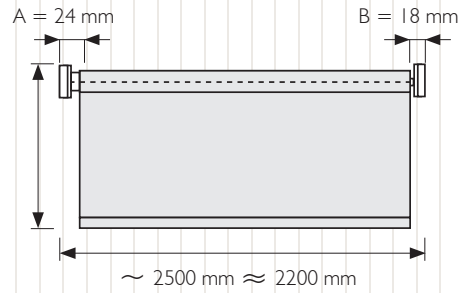
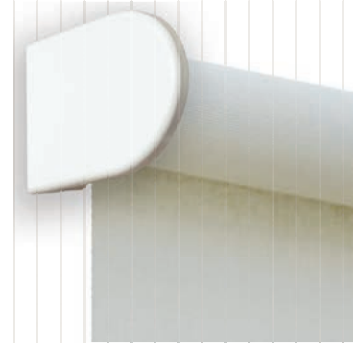

 **REN 40**

 RTS

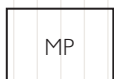
 MP

 S battery

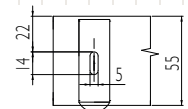
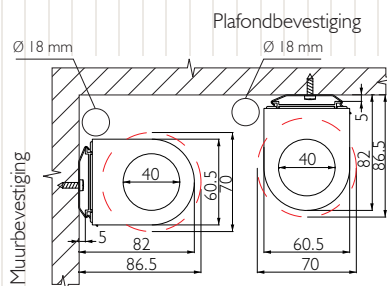
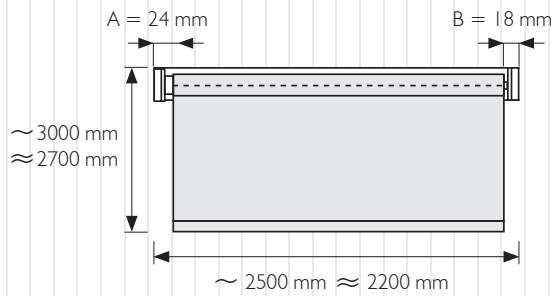

REN - TECHNISCH OVERZICHT

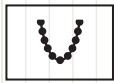

REN 47

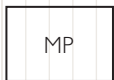
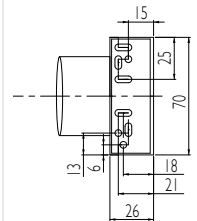
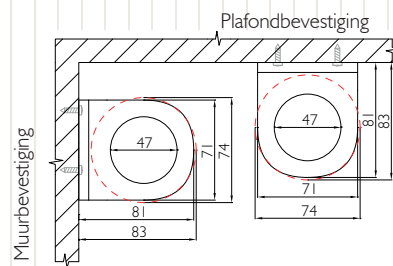
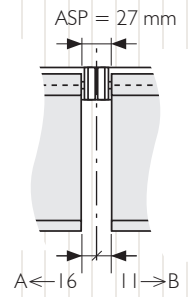
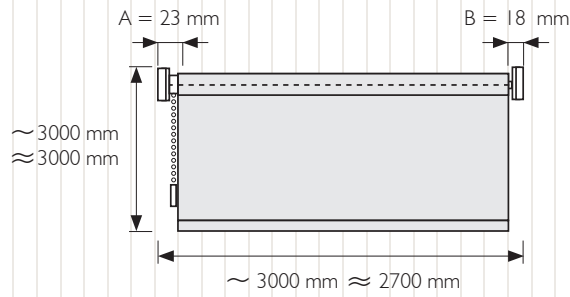

REN 47

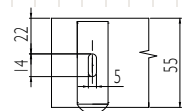
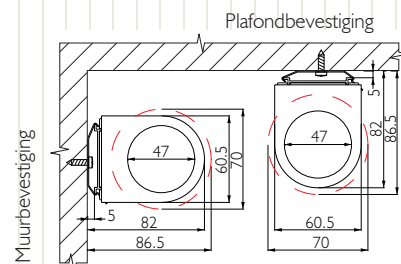
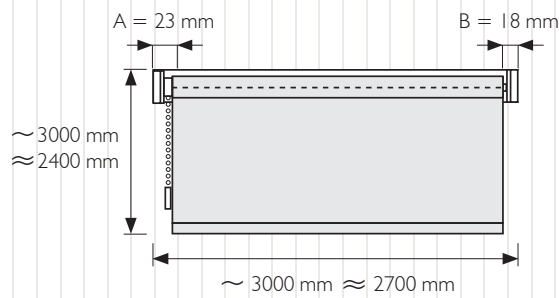

REN - TECHNISCH OVERZICHT

b & m

~ Lichte stof
 ~ Zware stof

De categorie waarin de stoffen worden ingedeeld kan u in de prijslijst terugvinden.



REN 47

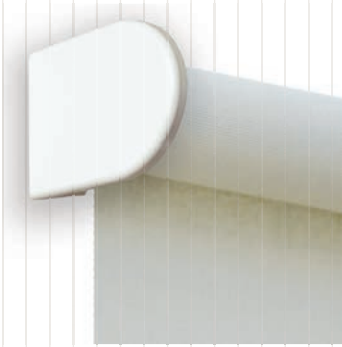

~ 3000 mm
 ~ 3000 mm

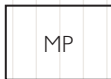
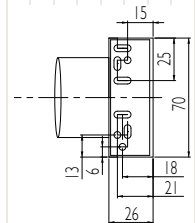
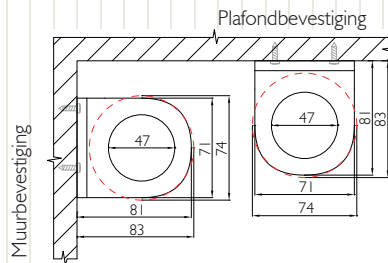
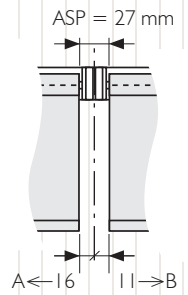
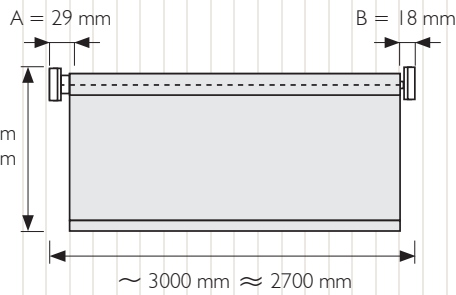

REN 47

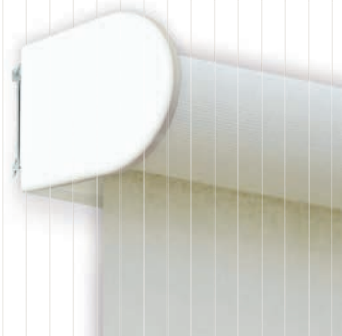

~ 3000 mm
 ~ 2400 mm

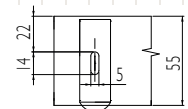
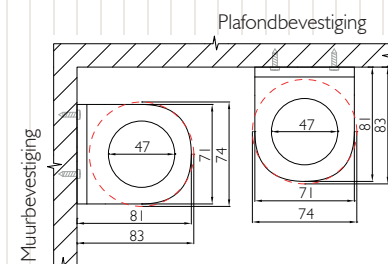
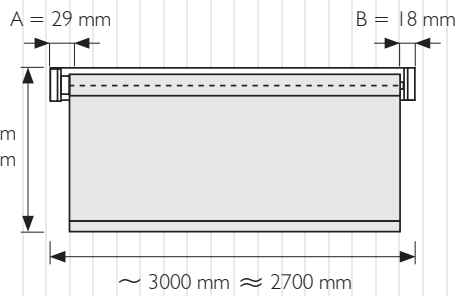

REN - TECHNISCH OVERZICHT



REN 47

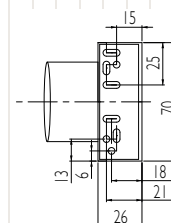
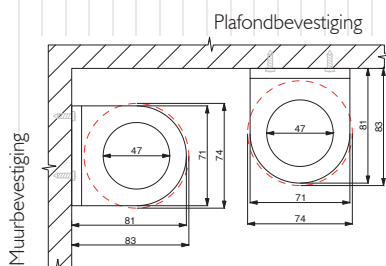
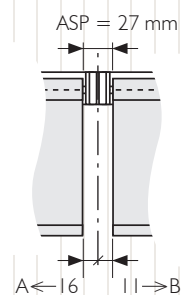
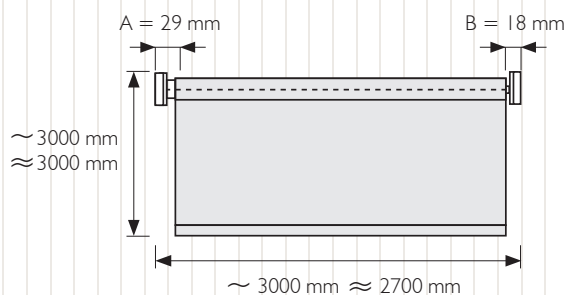
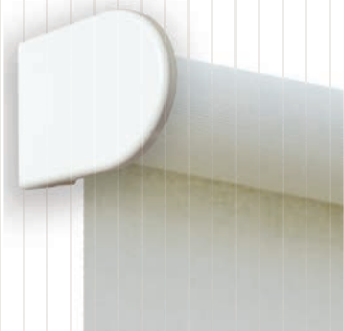

REN 47

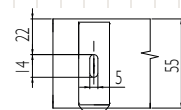
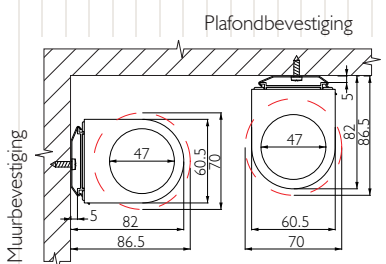
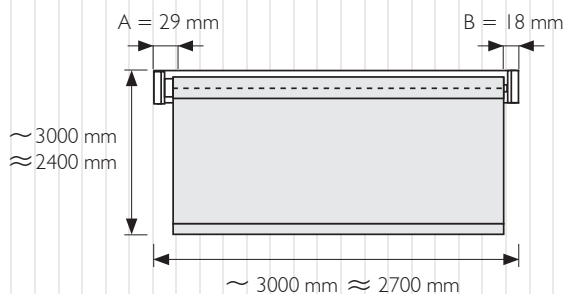
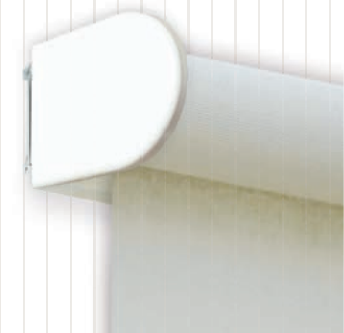
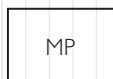

REN - TECHNISCH OVERZICHT



~ Lichte stof
 ≈ Zwارة stof

De categorie waarin de stoffen worden ingedeeld kan u in de prijslijst terugvinden.



REN 47

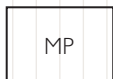
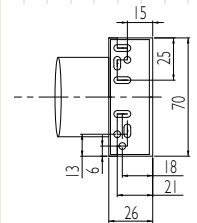
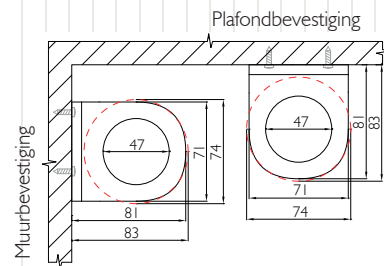
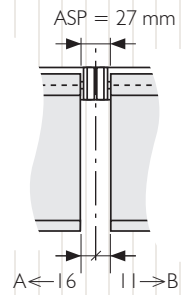
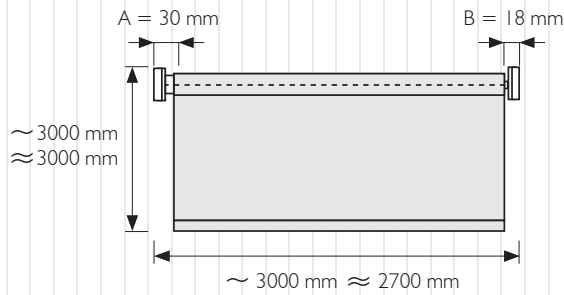
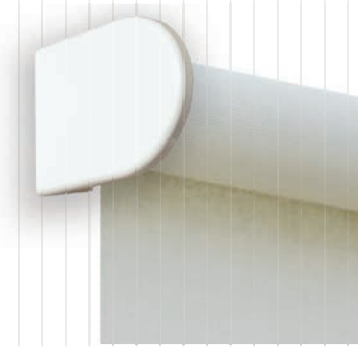

REN 47

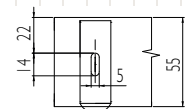
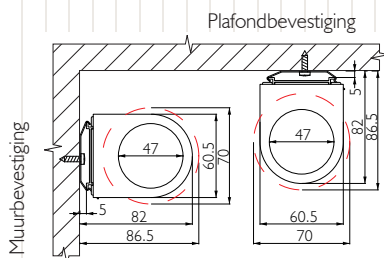
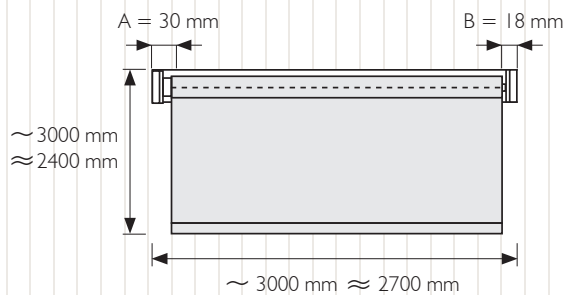
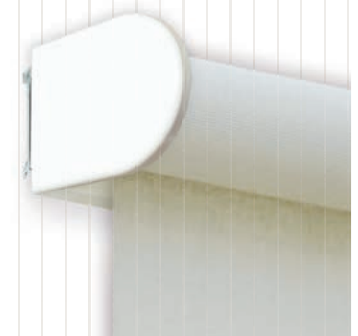

REN - TECHNISCH OVERZICHT



REN 47

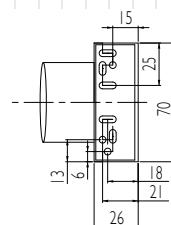
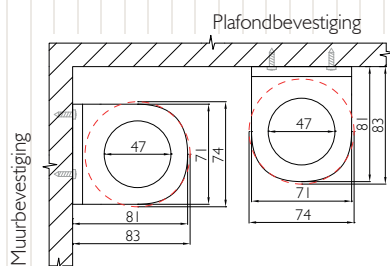
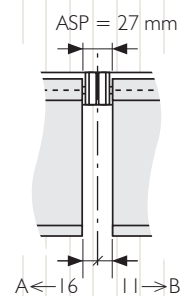
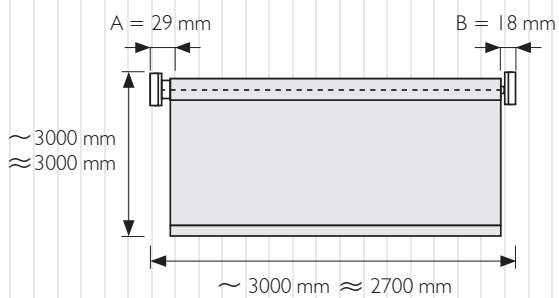
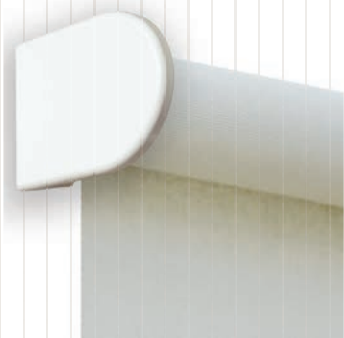

REN 47

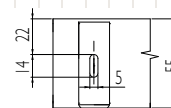
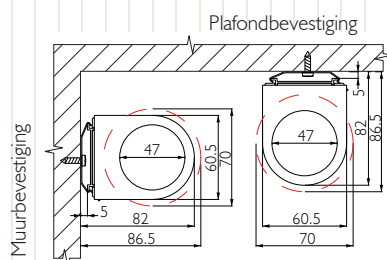
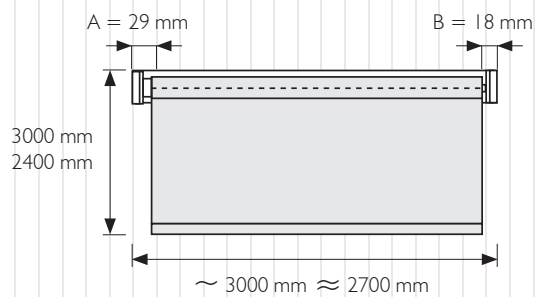
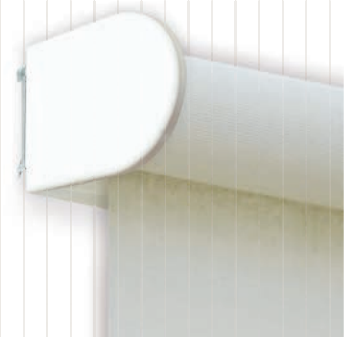
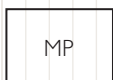

REN - TECHNISCH OVERZICHT

b & m

~ Lichte stof
 ~ Zware stof

De categorie waarin de stoffen worden ingedeeld kan u in de prijslijst terugvinden.



REN 54

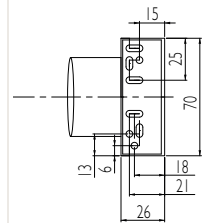
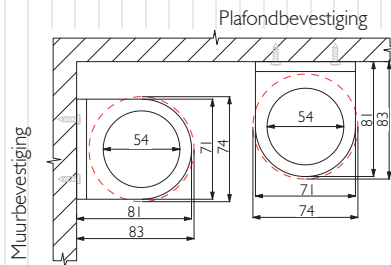
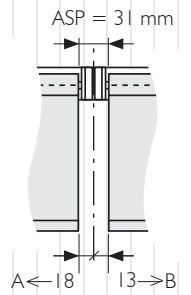
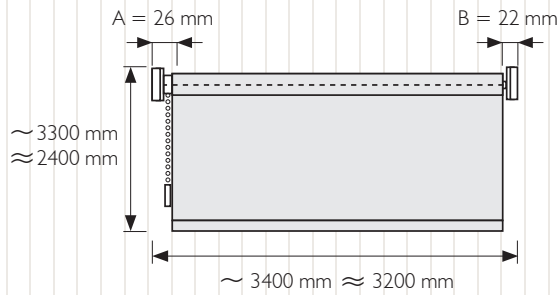

REN 54

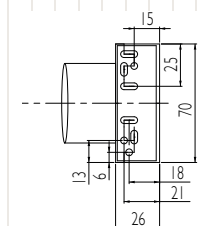
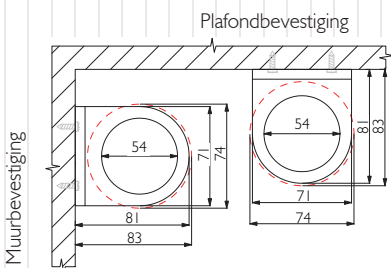
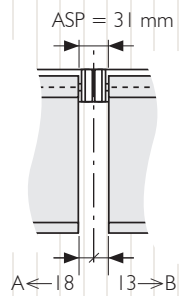
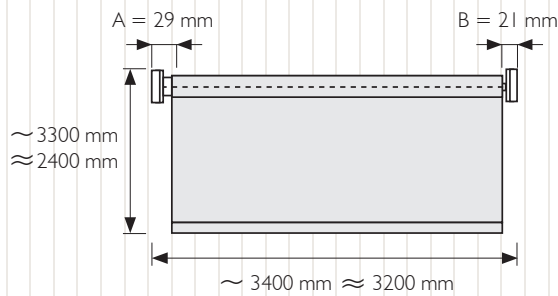
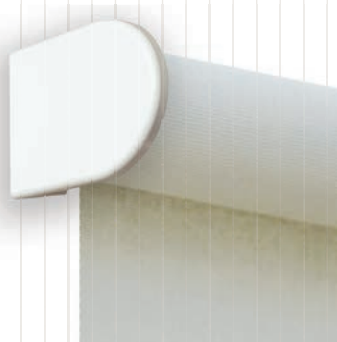

REN - TECHNISCH OVERZICHT



REN 54

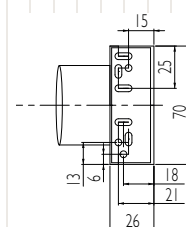
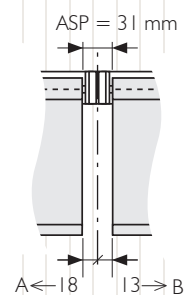
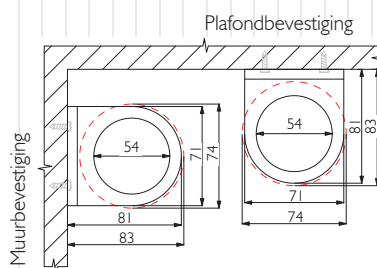
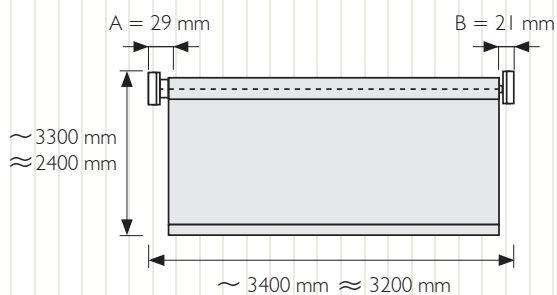
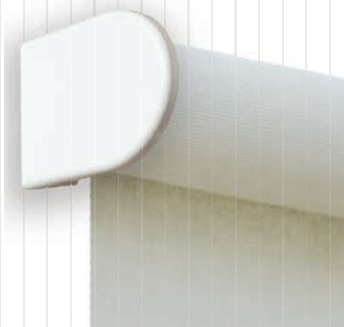

REN 54

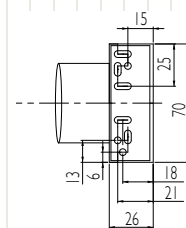
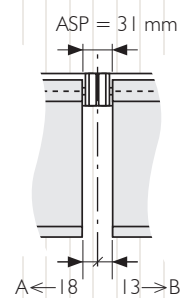
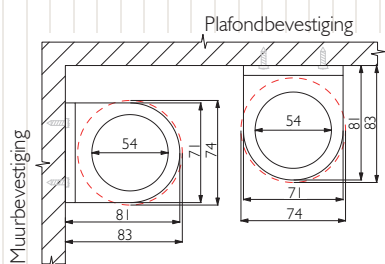
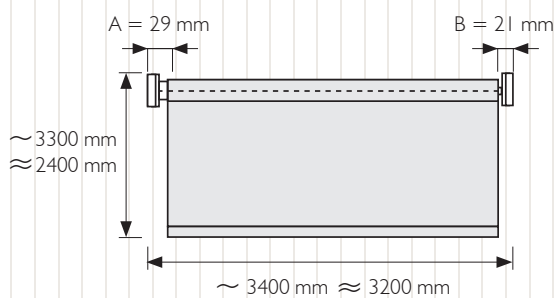

REN - TECHNISCH OVERZICHT



~ Lichte stof
 ~ Zware stof

De categorie waarin de stoffen worden ingedeeld kan u in de prijslijst terugvinden.

·) RTS **REN 54**

⏻ S 230 V

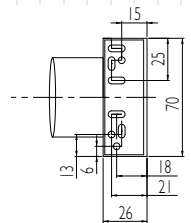
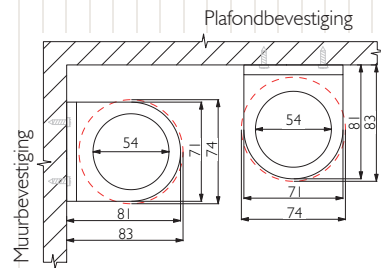
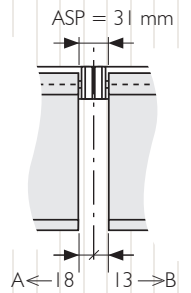
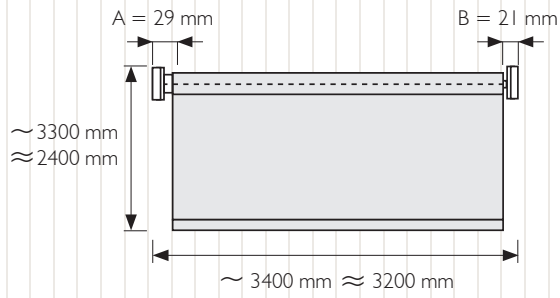
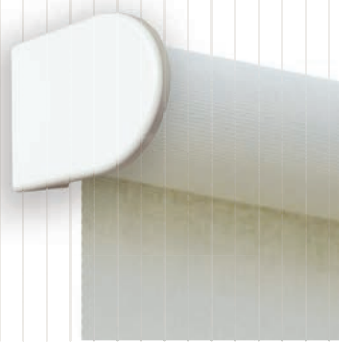

REN - TECHNISCH OVERZICHT

BOX

BOX 68R

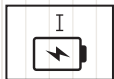
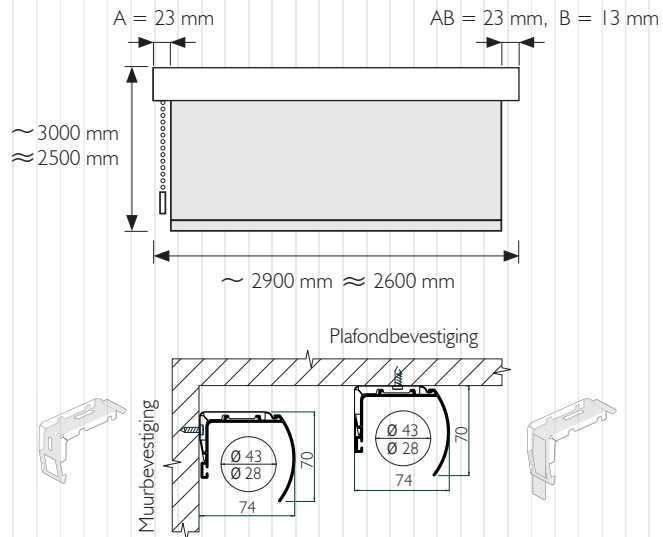
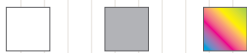

BOX 68R



BOX

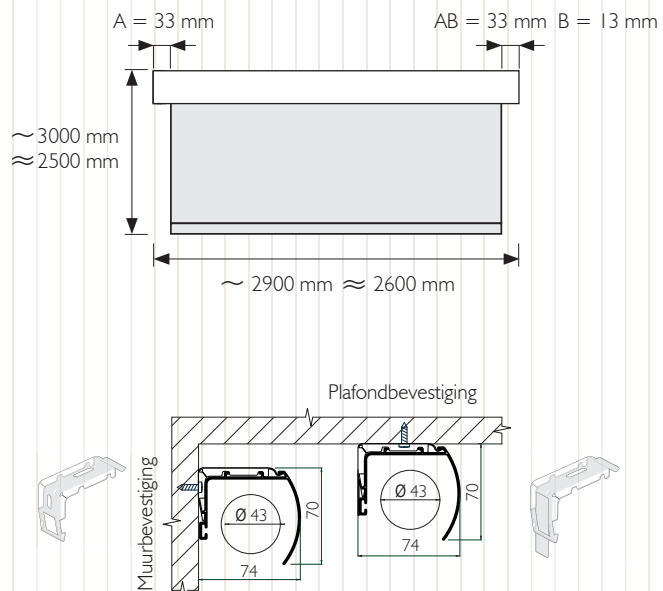
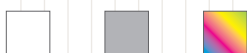

REN - TECHNISCH OVERZICHT

b & m

~ Lichte stof
≈ Zware stof

De categorie waarin de stoffen worden ingedeeld kan u in de prijslijst terugvinden.

BOX **BOX 68R**

⏻ A 230 V

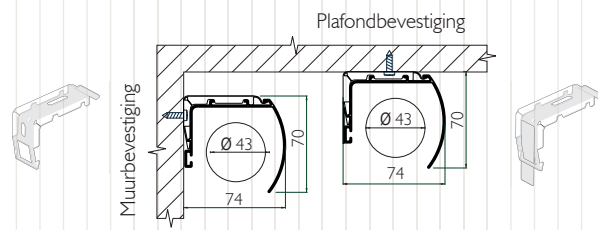
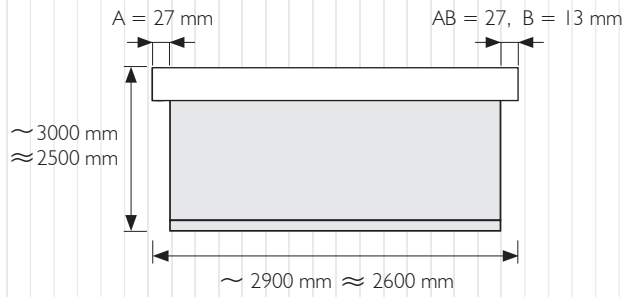

·) RTA **BOX 68R**

BOX

⏻ A 230 V

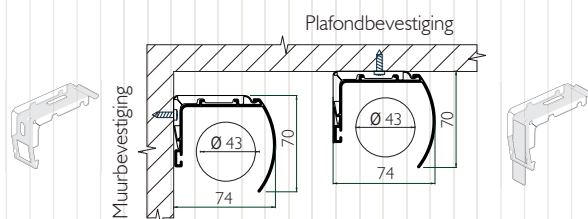
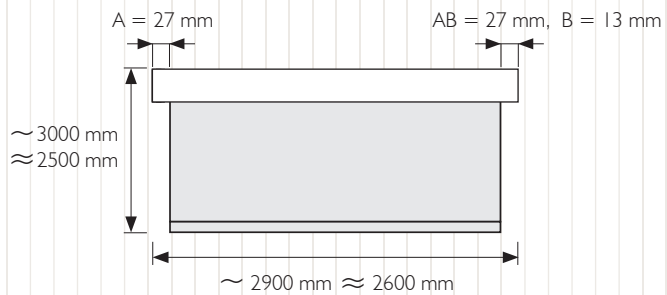
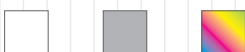

REN - TECHNISCH OVERZICHT



BOX 68R

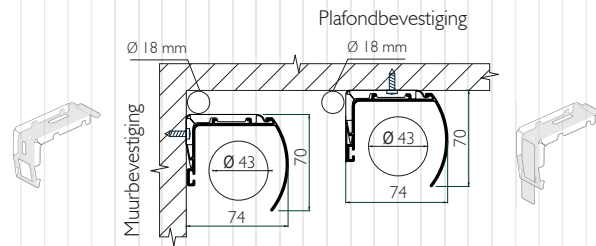
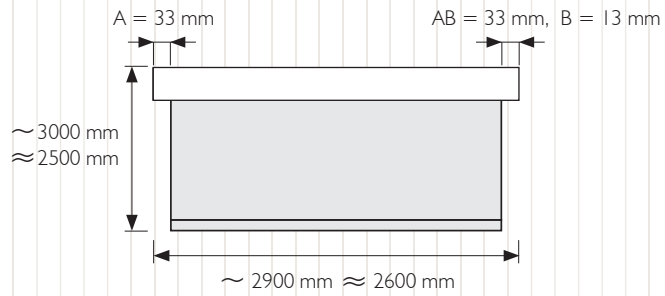

BOX 68R

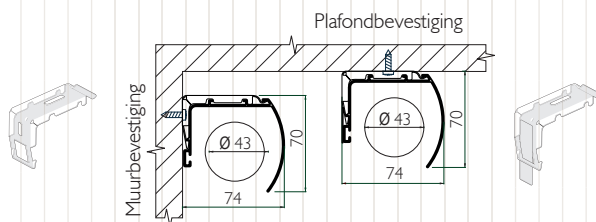
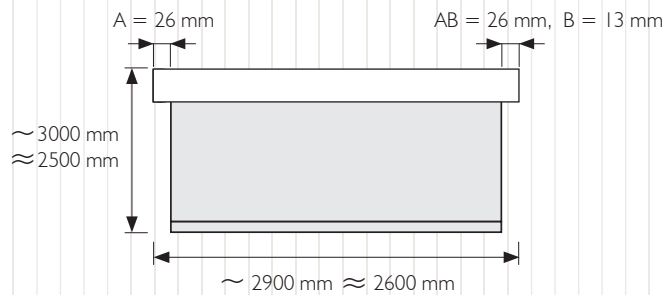
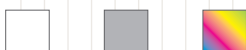

REN - TECHNISCH OVERZICHT

b & m

~ Lichte stof
 ≈ Zware stof

De categorie waarin de stoffen worden ingedeeld kan u in de prijslijst terugvinden.



BOX 68R

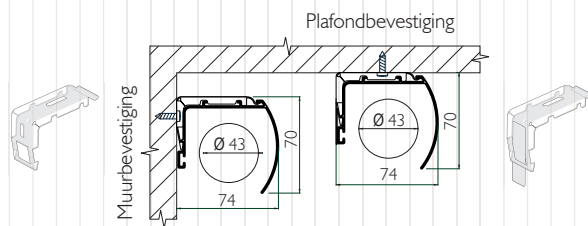
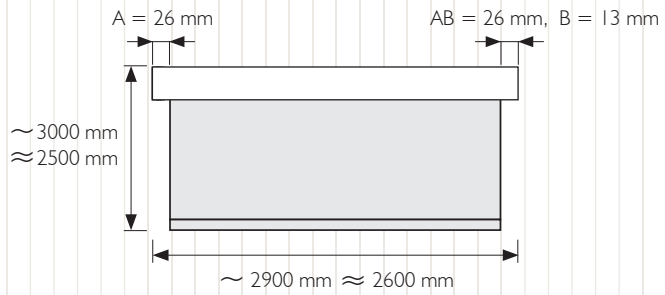
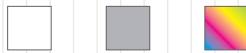

BOX 86R

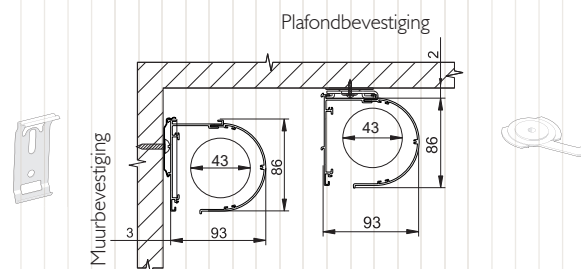
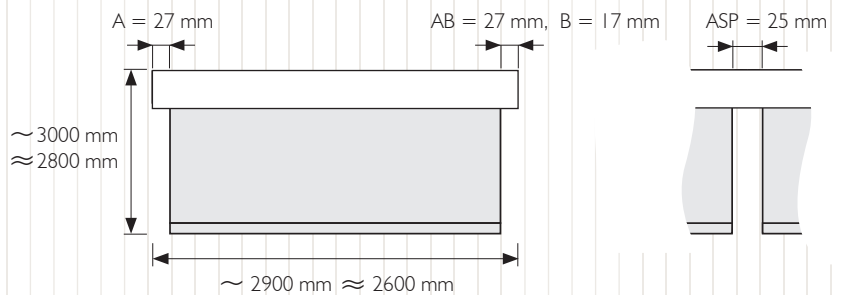
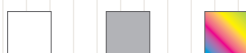

REN - TECHNISCH OVERZICHT

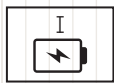

BOX 86R

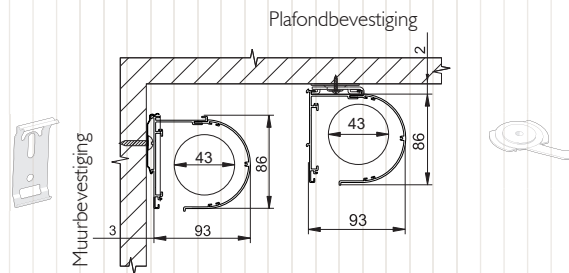
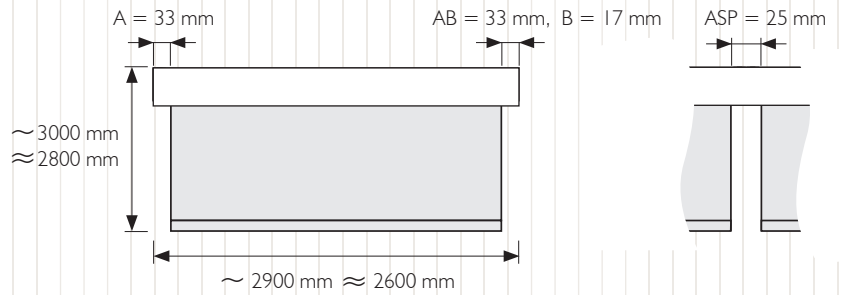
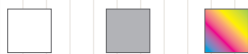

BOX 86R

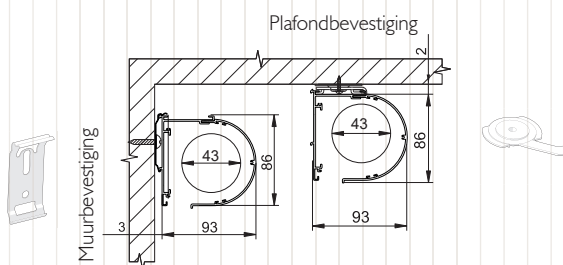
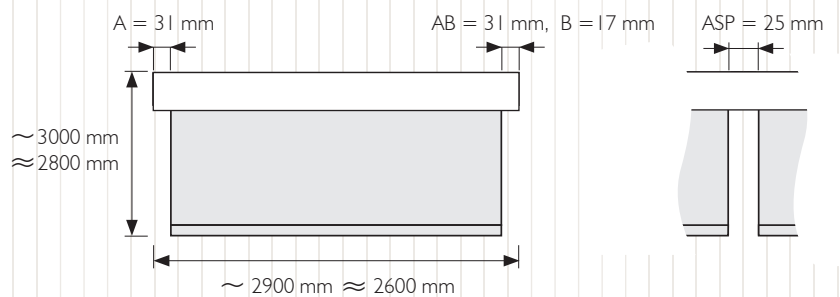
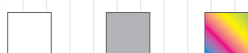

REN - TECHNISCH OVERZICHT

~ Lichte stof
 ≈ Zware stof

De categorie waarin de stoffen worden ingedeeld kan u in de prijslijst terugvinden.

·) RTA **BOX 86R**

BOX

⏻ A 230 V

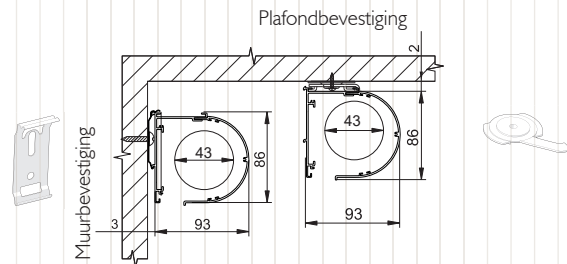
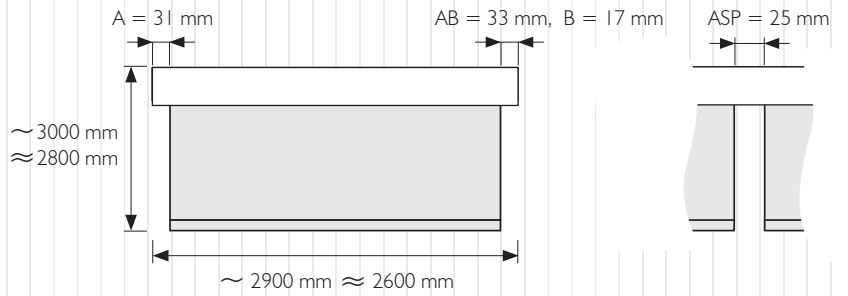
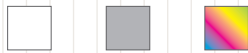

E **BOX 86R**

·) RTS

BOX

⏻ S battery

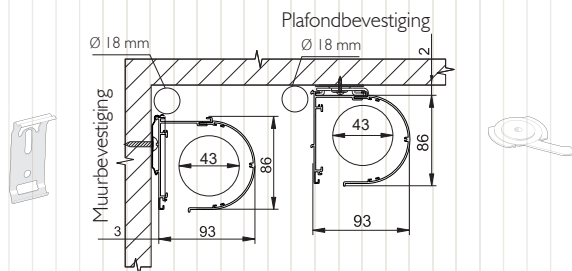
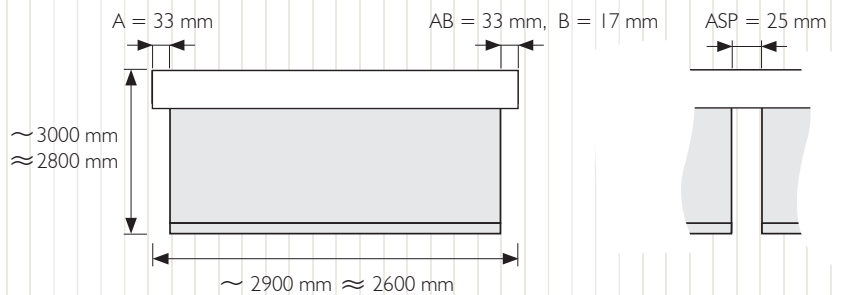
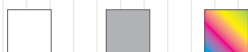

REN - TECHNISCH OVERZICHT

BOX **BOX 86R**

 S 230 V

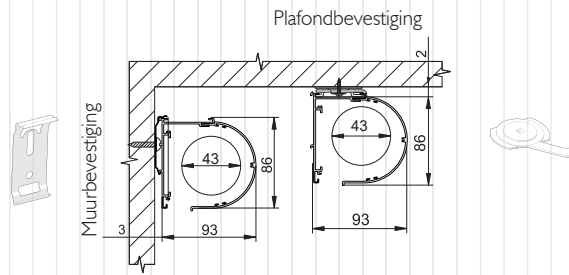
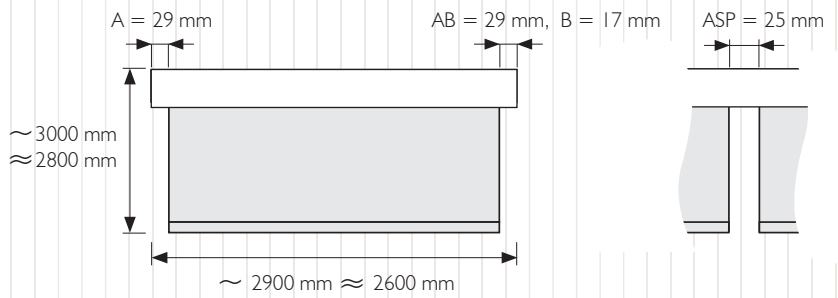

 **BOX 86R**

BOX

 S 230 V

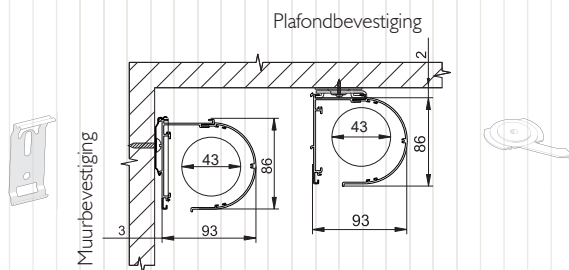
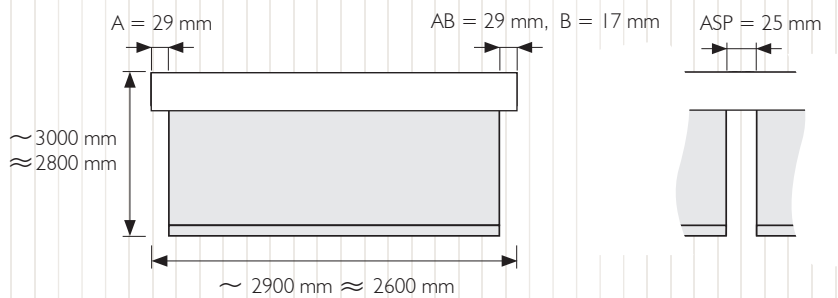
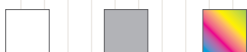
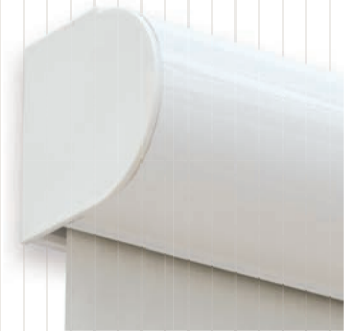

REN - TECHNISCH OVERZICHT

b & m

~ Lichte stof
 ≈ Zware stof

De categorie waarin de stoffen worden ingedeeld kan u in de prijslijst terugvinden.

BOX BOX 86S

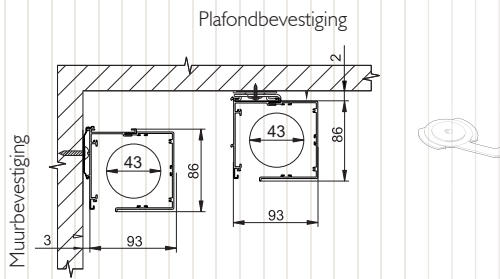
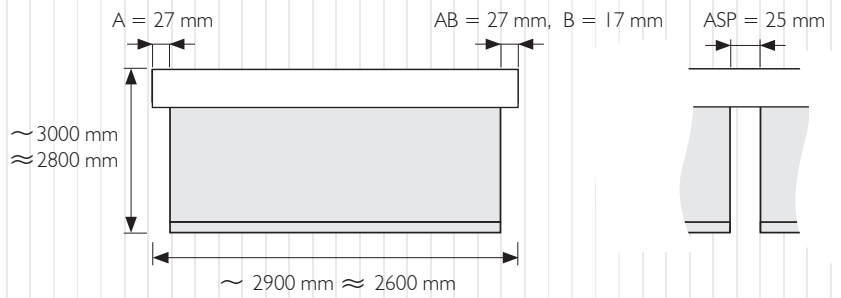
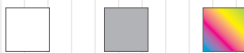

BOX BOX 86S

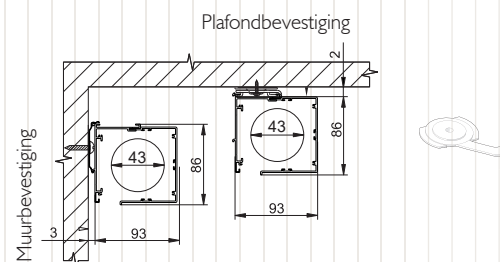
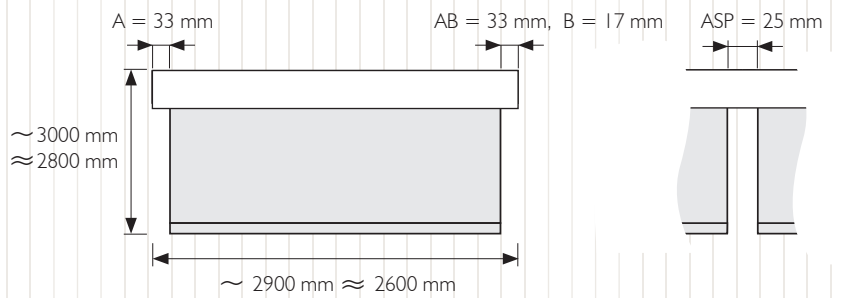
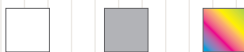
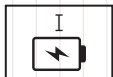

REN - TECHNISCH OVERZICHT

BOX **BOX 86S**

 A 230 V

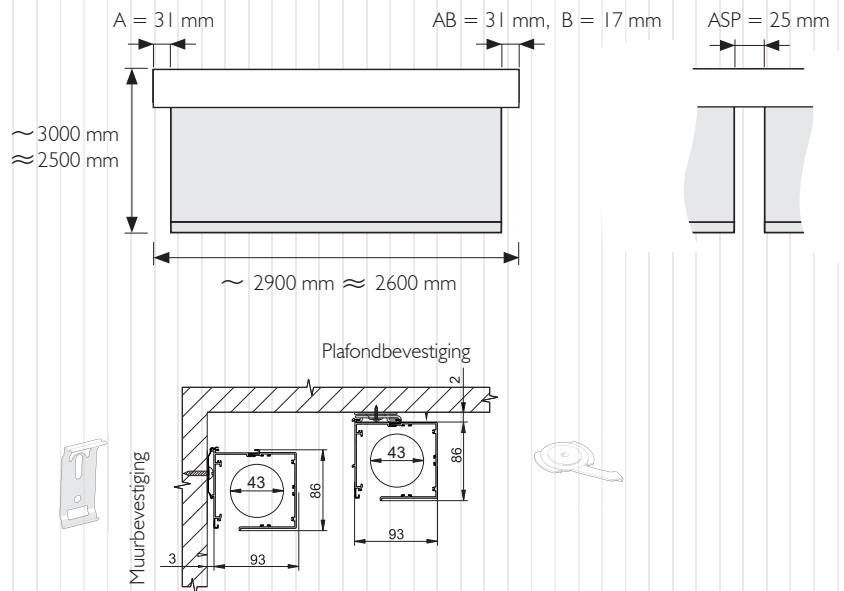
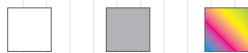

 RTA **BOX 86S**

BOX

 A 230 V

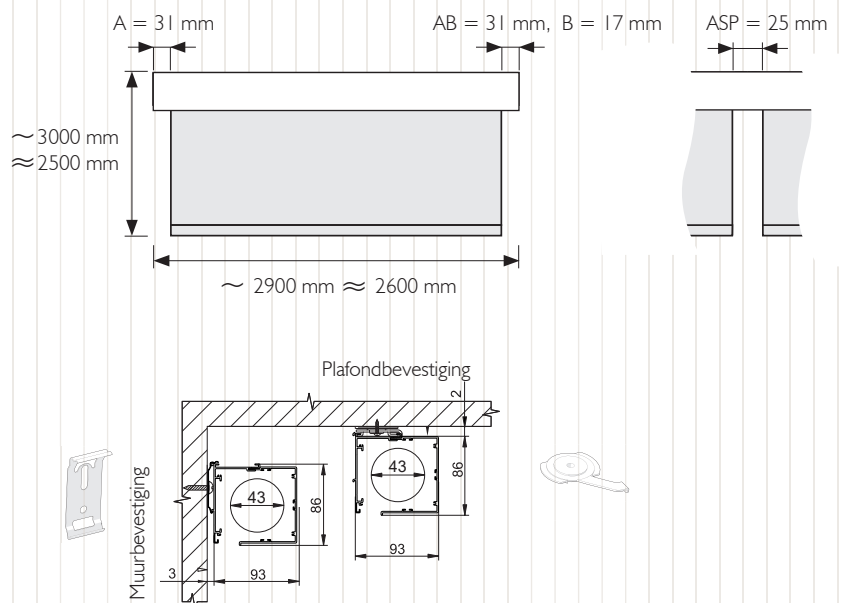
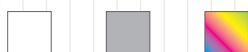
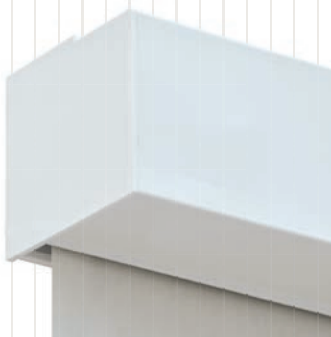

REN - TECHNISCH OVERZICHT

b & m

~ Lichte stof
 ~ Zware stof

De categorie waarin de stoffen worden ingedeeld kan u in de prijslijst terugvinden.

BOX 86S

RTS

BOX

S battery

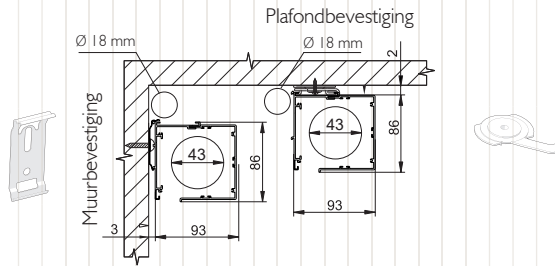
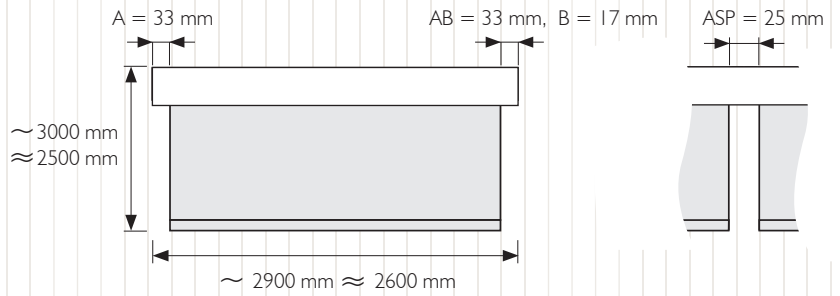
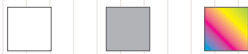
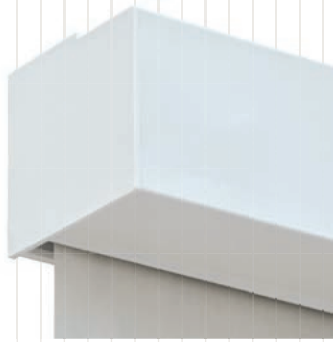

BOX 86S

S 230 V

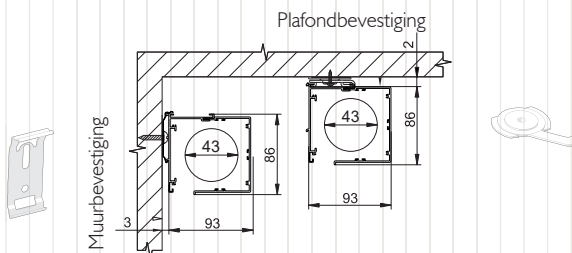
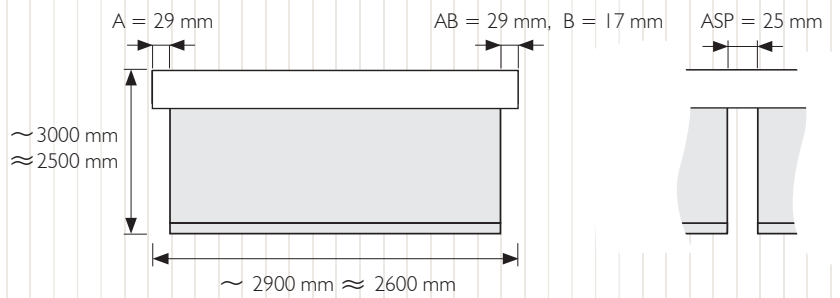
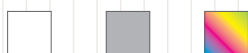
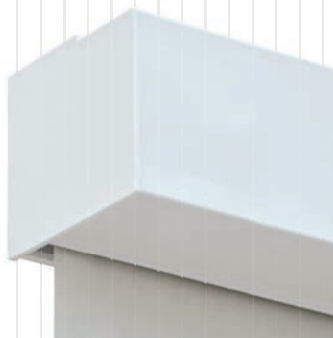

REN - TECHNISCH OVERZICHT



BOX 86S

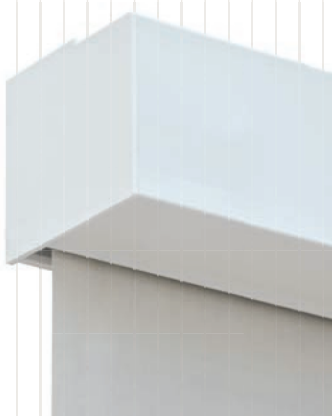

~ 3000 mm
~ 2500 mm

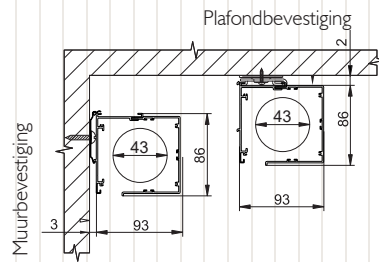
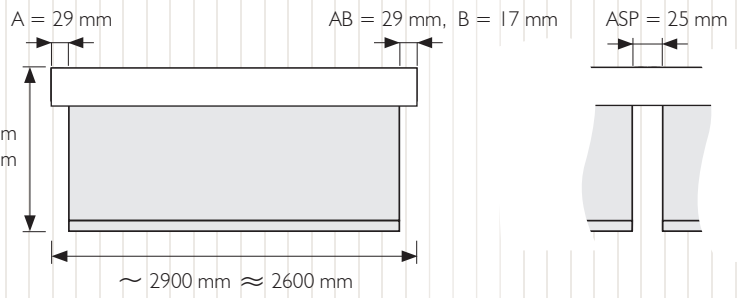

REN - TECHNISCH OVERZICHT

b & m

~ Lichte stof
 ~ Zware stof

De categorie waarin de stoffen worden ingedeeld kan u in de prijslijst terugvinden.

REN N DARK 86R



Wit
 Grijs
 RAL

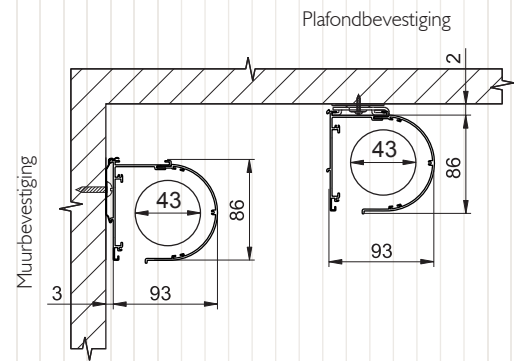

Gemotoriseerd systeem met ketting

Maximum afmetingen (mm)	Breedte	2500	
	Hoogte, dunne / dikke stof	2500	2500

Afmetingen en bevestiging van zijgeleiding

Geleiding: 44 × 33 mm

Voor muur- en plafondbevestiging.

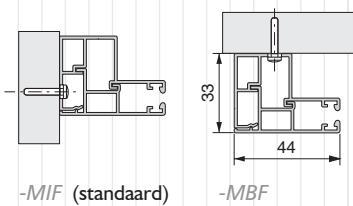

Hoogte van de zijgeleiding (L)

Afmetingen van de onderlat

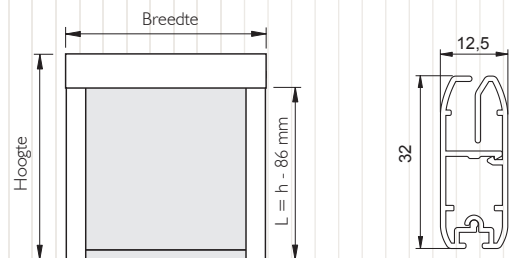

Kabelmogelijkheden

Achterzijde

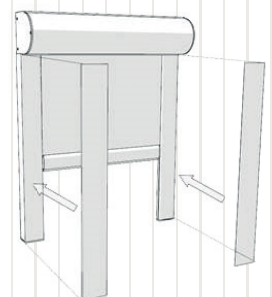
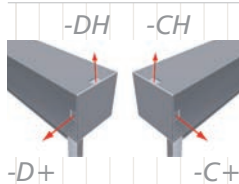

REN - TECHNISCH OVERZICHT



REN N DARK 86S



Wit
 Grijs
 RAL

Gemotoriseerd systeem met ketting

Maximum afmetingen (mm)	Breedte	2500	
	Hoogte, dunne / dikke stof	2500	2500

Afmetingen en bevestiging van zijgeleiding

Geleiding: 44 × 33 mm

Voor muur- en plafondbevestiging.

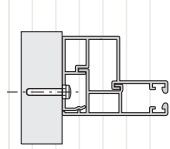

-MIF (standaard)

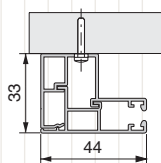

-MBF

Kabelmogelijkheden

Achterzijde

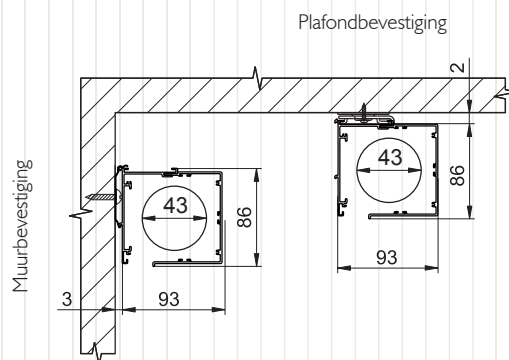
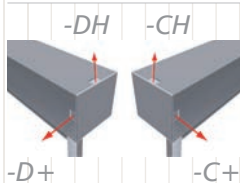

Hoogte van de zijgeleiding (L)

Afmetingen van de onderlat

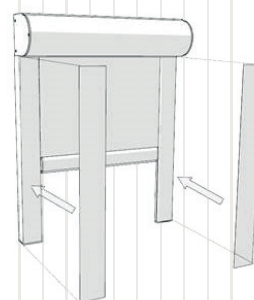
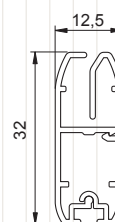
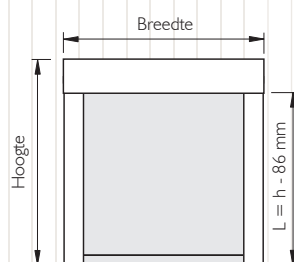



3. BIG

3.1 ALGEMENE INFO

80 CM LENGTE



500 CM LENGTE

DIAMETER 63 MM T.E.M. 115 MM

BOX ROUND: NIET MOGELIJK BIJ EEN 'BIG'-SYSTEEM

BOX SQUARE: 89-103

ZIJGELEIDER: ENKEL 103

BOX 89 TOT 300 CM

BOX 103 TOT 400 CM

OPEN SYSTEEM 500 CM

MOTOR ENKEL 230 V

ONDERLAT 340 MM, EN GROTER DAN 340 ENKEL BEPAALDE SELECTIE MOGELIJK= G/H/I/I2

3.2. STEUNTJES

3.2.1 STEUNTJES STANDAARD



SMALL

Afmetingen: buis 63- 78

□ ■ ■ + any color you want

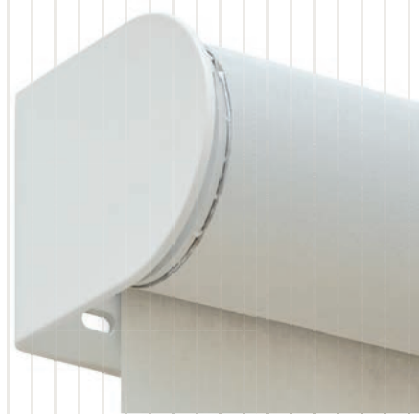

LARGE

Afmetingen: buis 95- 115

□ ■ ■ + any color you want

3.2.2 KOVEN/BOX

Bij het BIG-systeem kan je enkel een rechte box kiezen.

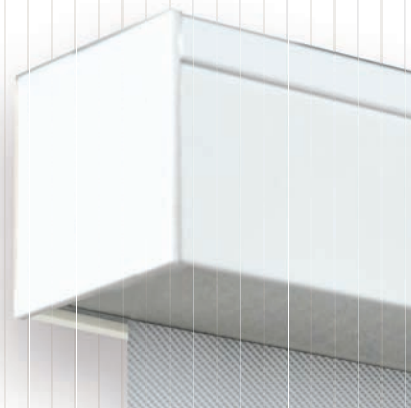

KOOF RECHT

Afmetingen: box 89 en 103

Er zijn vaste ophangpunten voorzien voor deze boxen, voor afwijkingen: gelieve contact op te nemen.

3.2.3 CASSETTE BIG

BIG N DARK

Verduisterend cassettesysteem met ritsen.



BIG N DARK 89

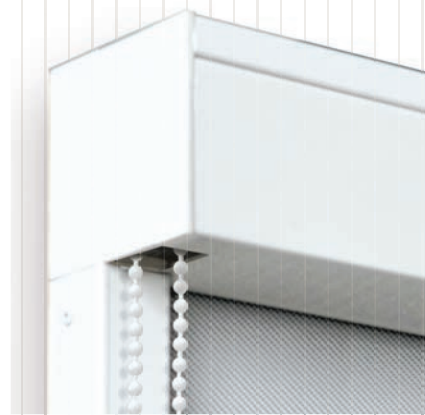

BIG N DARK 103

3.2.4 ZIJGELEIDING

Bij zijgeleiding is het niet mogelijk om metalen steuntjes te gebruiken.
Het is ook niet mogelijk de accessoires te verven.
Zijgeleiding is niet mogelijk voor contrarollende systemen.

Onderlat B-VL

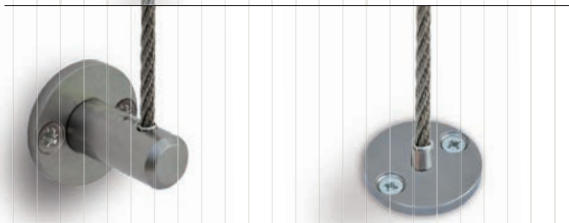
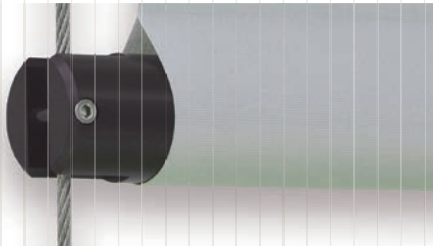

GELEIDING

Basis - muur

Basis - vloer

3.3 BEDIENING

3.3.1 ELEKTRISCHE BEDIENING

BEDRADE SYSTEMEN

Voeding	Bediening
230 V A BM-motor	<ul style="list-style-type: none"> - Draadloze BM-afstandsbediening - Schakelaar/domotica
230 V S Somfy-motor	<ul style="list-style-type: none"> - Telis- & Modulis-afstandsbediening - Schakelaar/domotica

Opgelet: standaard komen alle BIG-systemen gemotoriseerd. Op aanvraag kunnen deze ook bediend geleverd worden met hulpveer, dit zonder meerprijs.

3.4 OPMETEN

Spannende breedte - 1 cm

Loodrechte montage is vereist.

Zorgenvrij: we hebben ook een meet-en plaatsingsdienst.

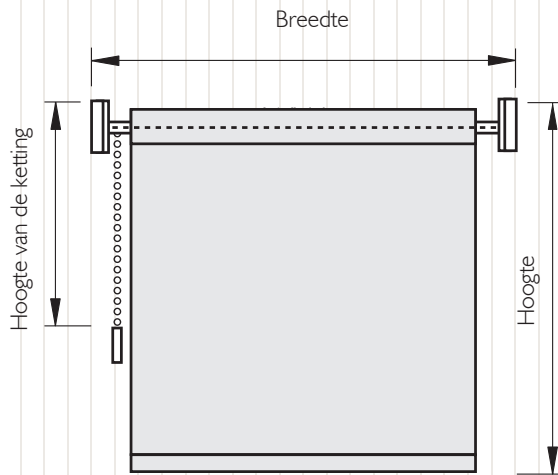

Muurbevestiging

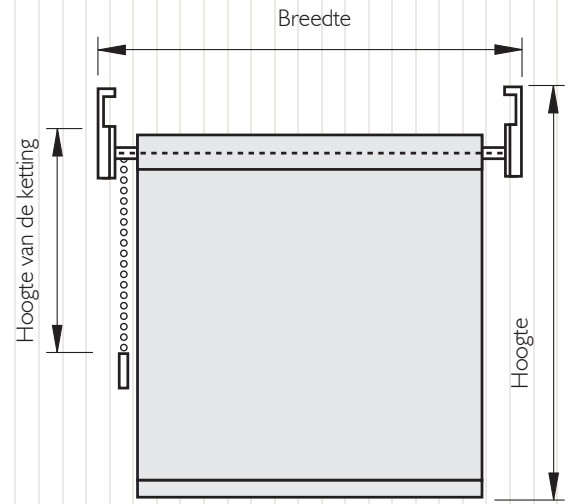

Plafondbevestiging

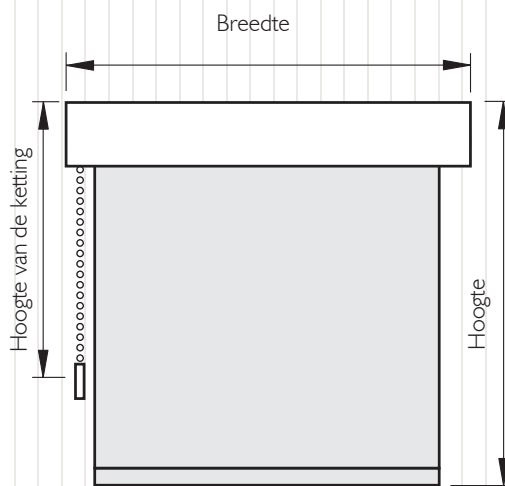

Box

!

Indien de breedte van het systeem $1/3$ smaller is dan de hoogte kunnen geen perfecte werking garanderen.

Als de bevestigingskeuze niet gespecificeerd is, kiest Bmfabrics een standaard muurbevestiging.

We reduceren de maximumbreedte met 20-30 cm voor zware stoffen en stoffen die krimpen.

BIG - TECHNISCH OVERZICHT

3.5 TECHNISCH OVERZICHT



BIG 63

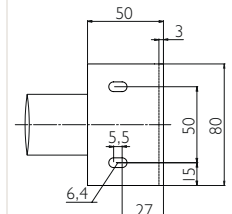
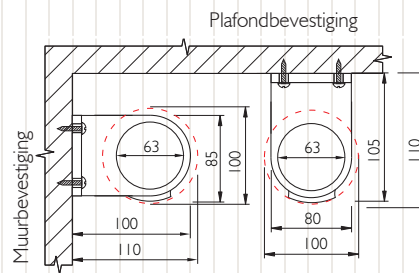
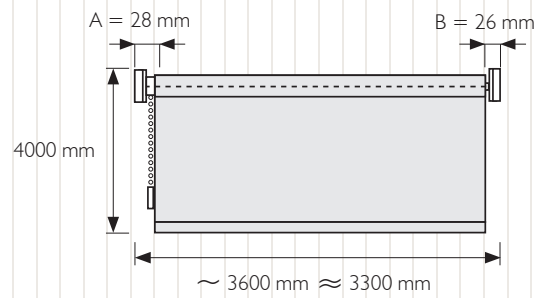

BIG 63

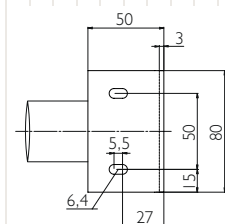
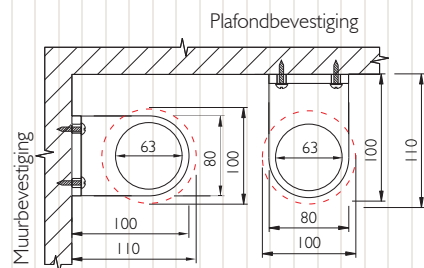
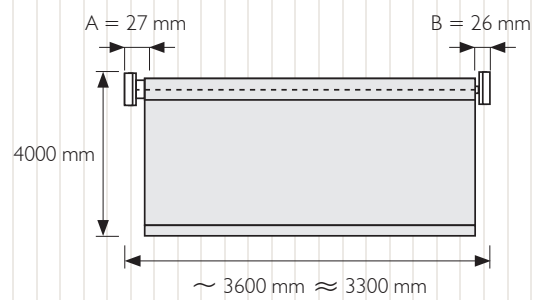

BIG - TECHNISCH OVERZICHT



~ Lichte stof
 ≈ Zware stof

De categorie waarin de stoffen worden ingedeeld kan u in de prijslijst terugvinden.

·) RTA **BIG 63**

⏻ A 230 V

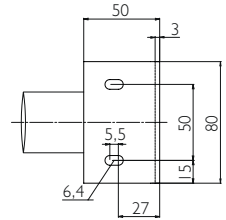
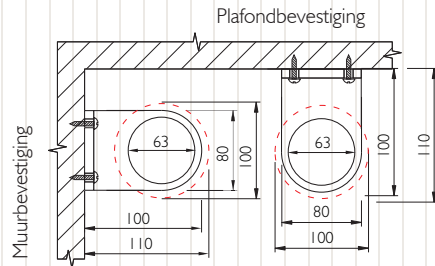
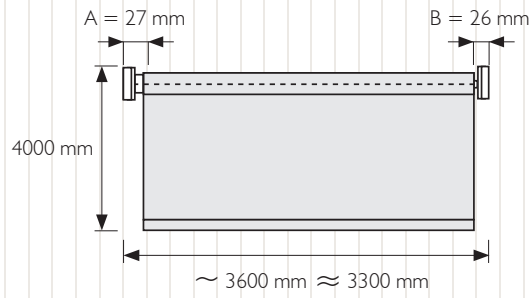

⏻ S 230 V **BIG 63**

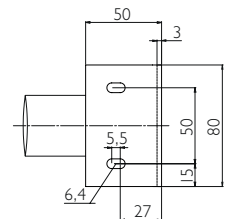
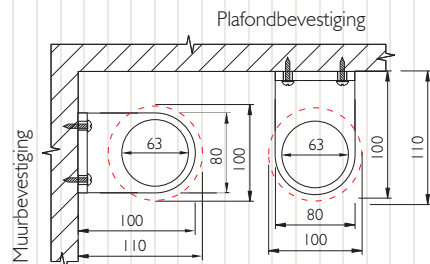
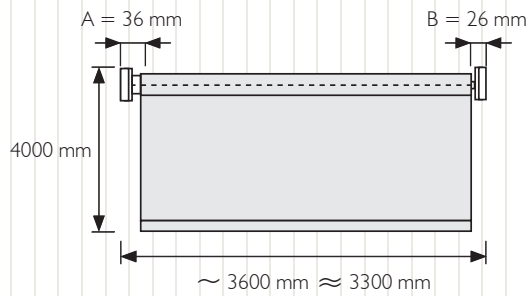

BIG - TECHNISCH OVERZICHT



BIG 63

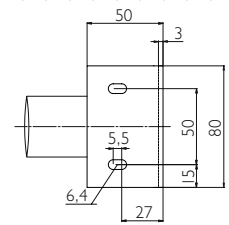
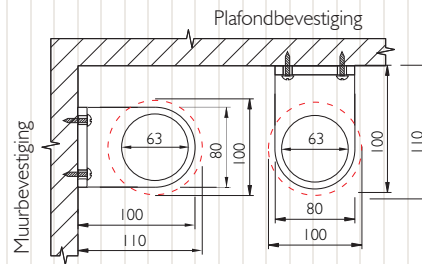
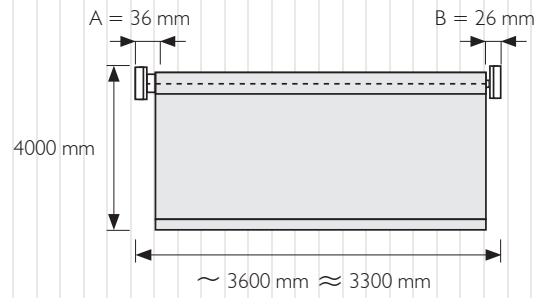

BIG 78

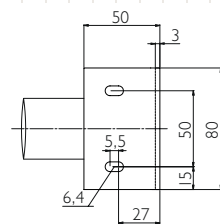
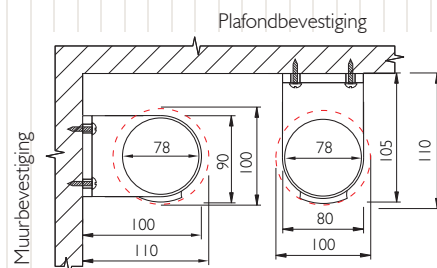
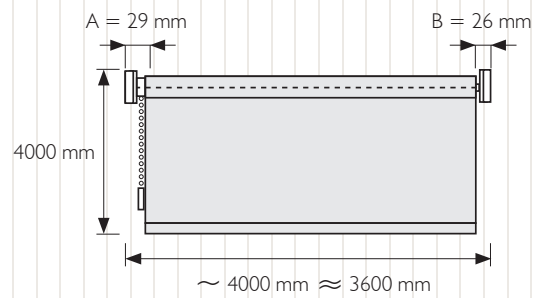

BIG - TECHNISCH OVERZICHT

b & m

~ Lichte stof
 ≈ Zware stof

De categorie waarin de stoffen worden ingedeeld kan u in de prijslijst terugvinden.



BIG 78

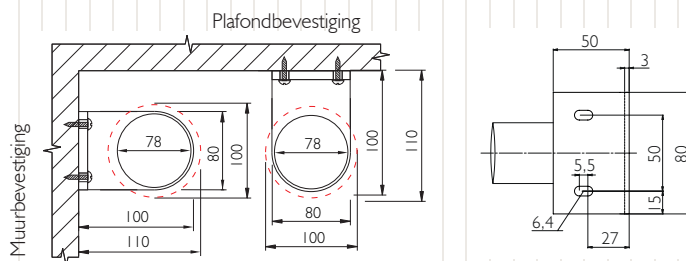
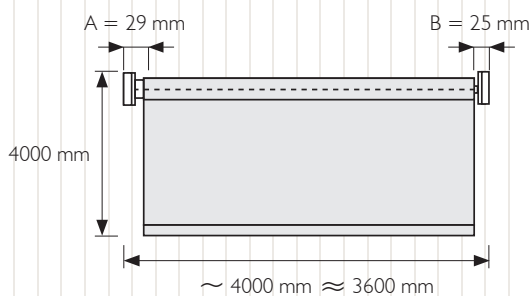

BIG 78

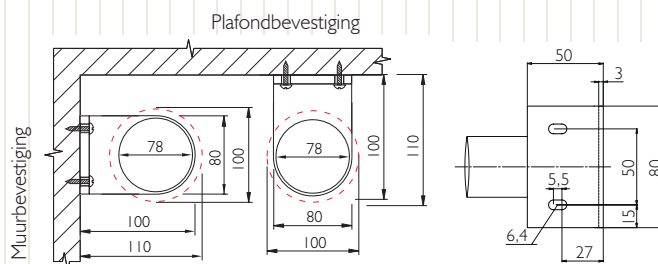
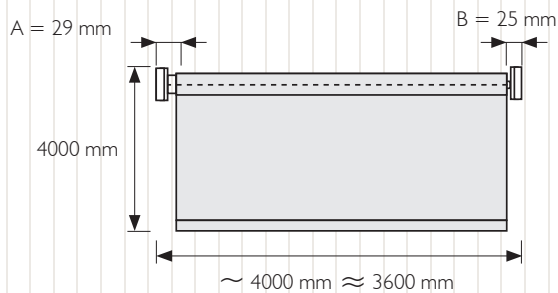

BIG - TECHNISCH OVERZICHT



BIG 78

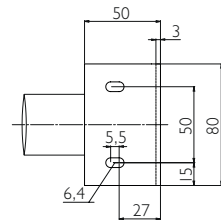
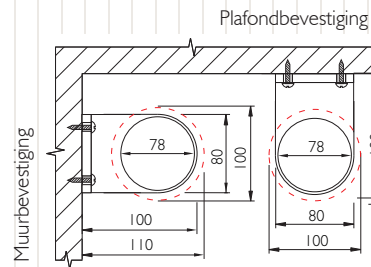
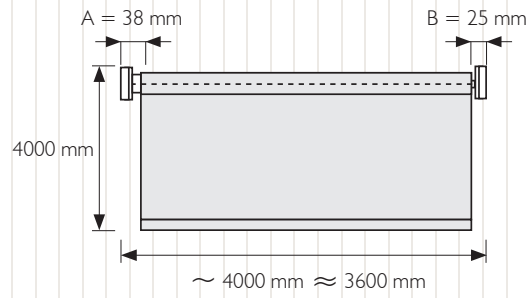

BIG 78

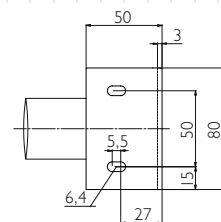
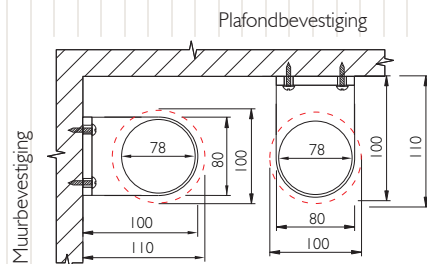
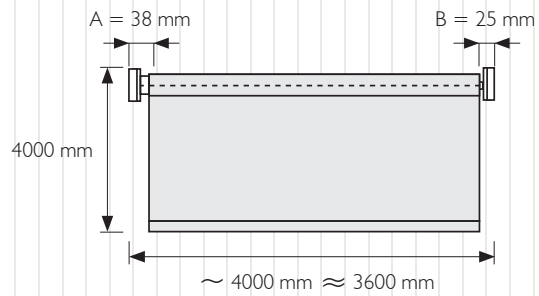

BIG - TECHNISCH OVERZICHT

b & m

~ Lichte stof
 ~ Zware stof

De categorie waarin de stoffen worden ingedeeld kan u in de prijslijst terugvinden.



BIG 95

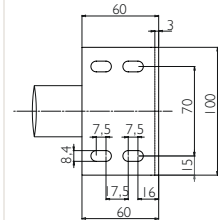
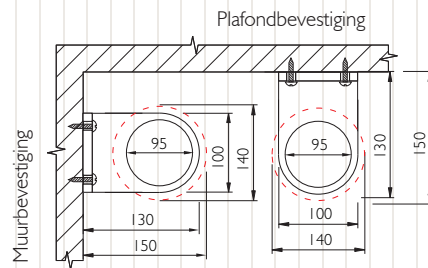
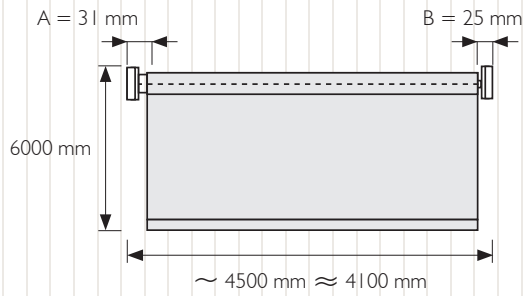

BIG 95

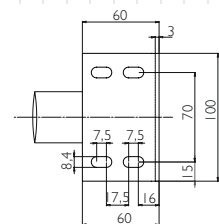
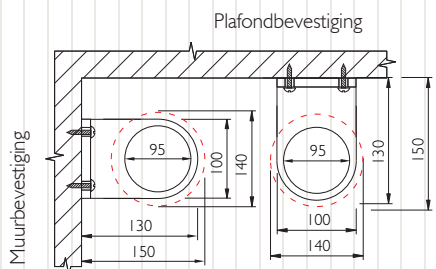
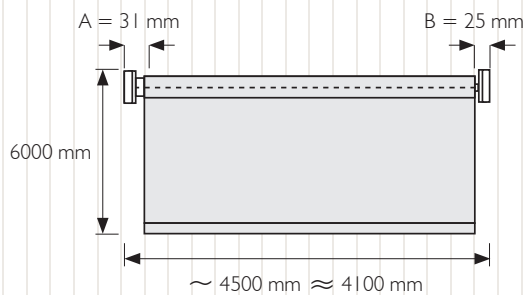

BIG - TECHNISCH OVERZICHT



BIG 95

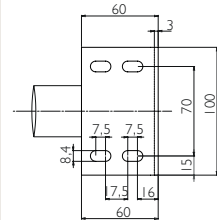
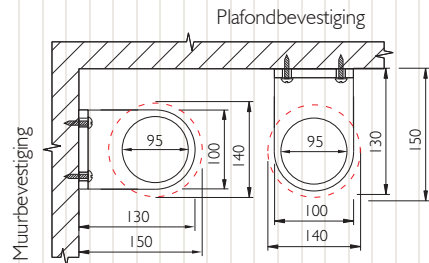
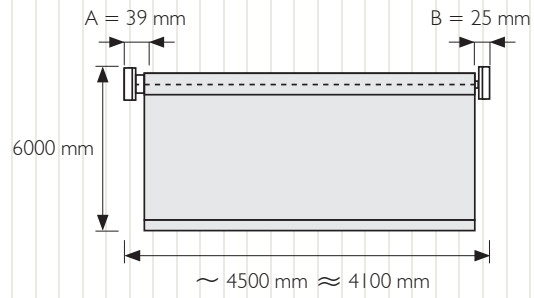

BIG 95

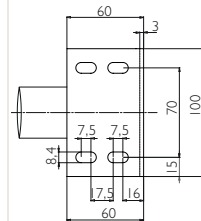
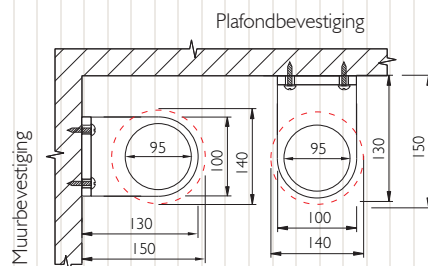
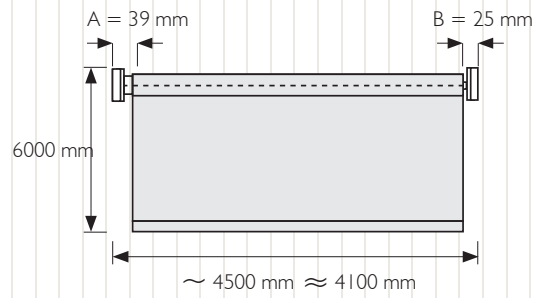

BIG - TECHNISCH OVERZICHT



~ Lichte stof
 ~ Zware stof

De categorie waarin de stoffen worden ingedeeld kan u in de prijslijst terugvinden.



BIG 115

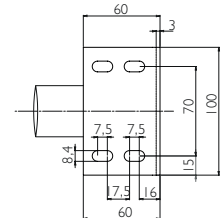
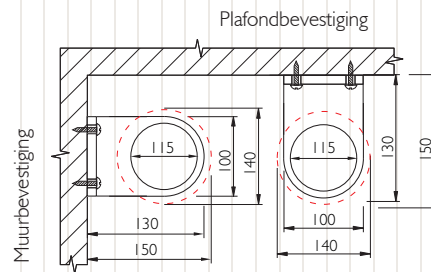
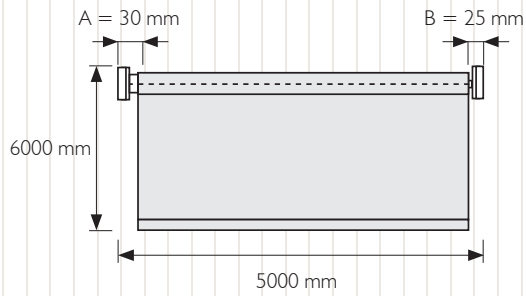

BIG 115

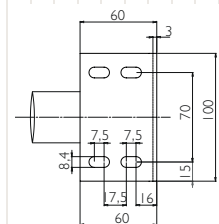
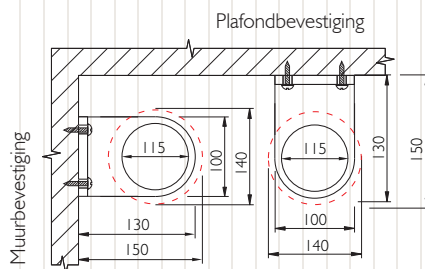
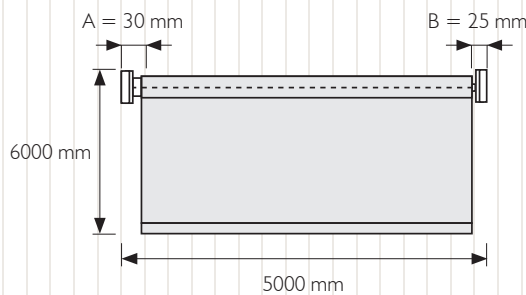

BIG - TECHNISCH OVERZICHT



BIG 115

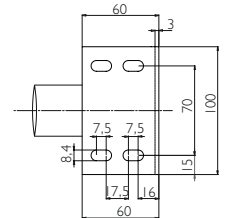
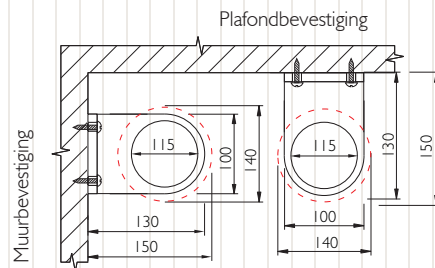
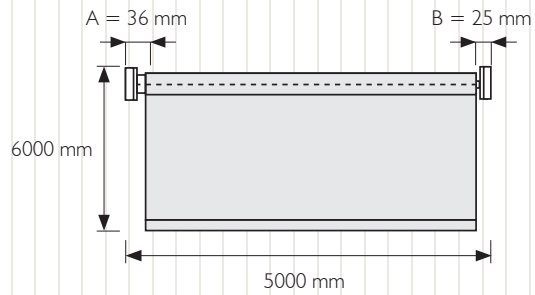

BIG 115

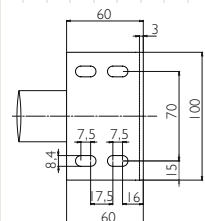
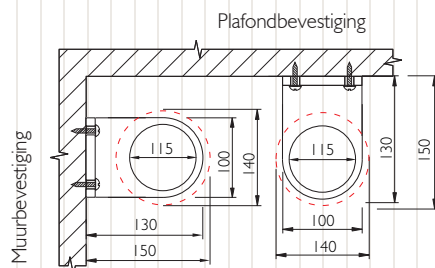
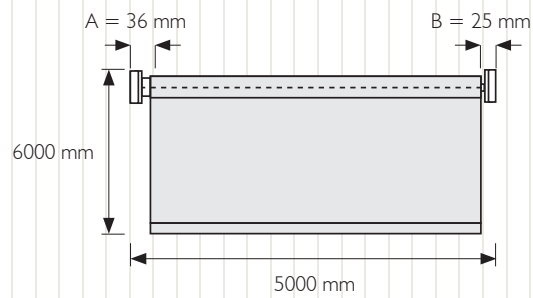

BIG - TECHNISCH OVERZICHT

b & m

~ Lichte stof
 ≈ Zware stof

De categorie waarin de stoffen worden ingedeeld kan u in de prijslijst terugvinden.

BOX

BOX BIG 89S

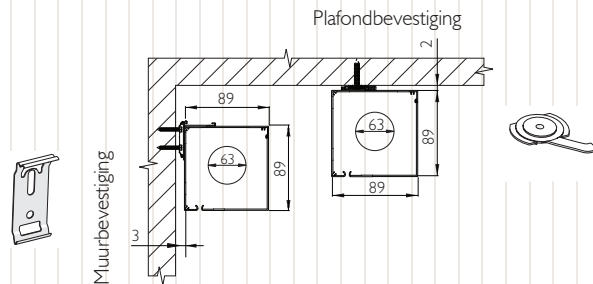
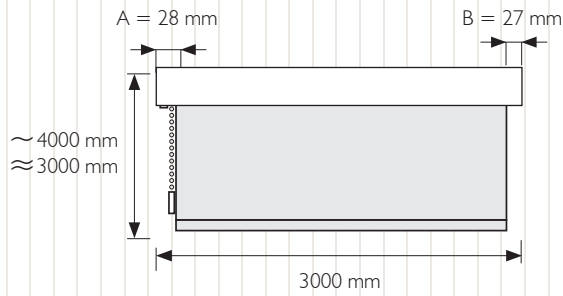
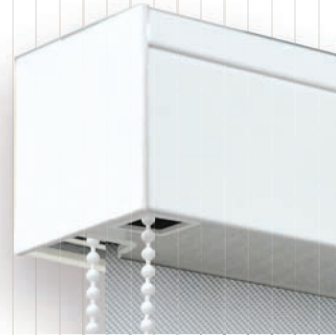

BOX

BOX BIG 89S

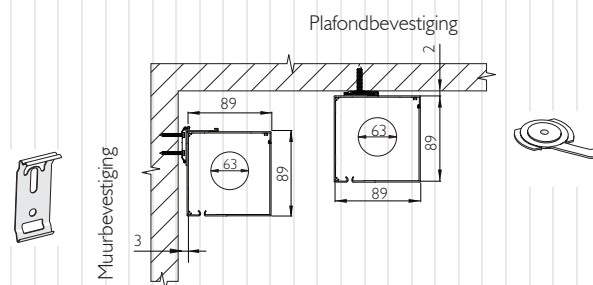
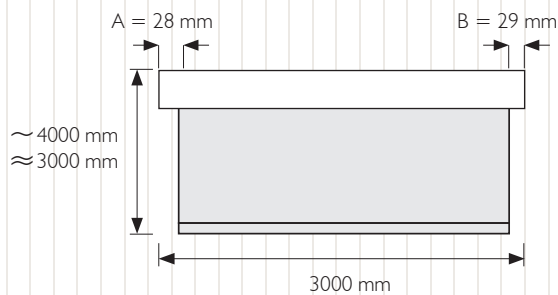
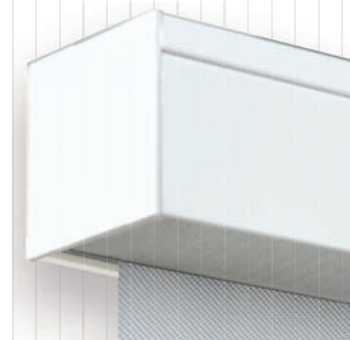

BIG - TECHNISCH OVERZICHT

BOX BIG 89S

BOX

RTA

230 V

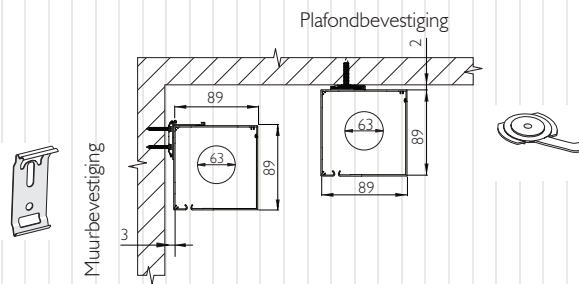
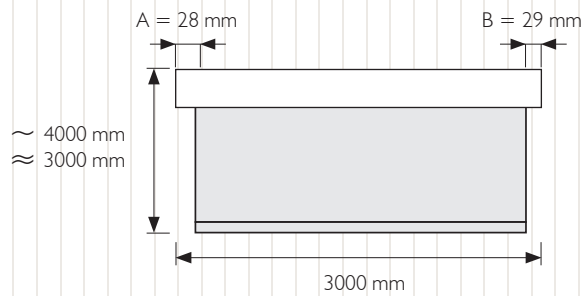
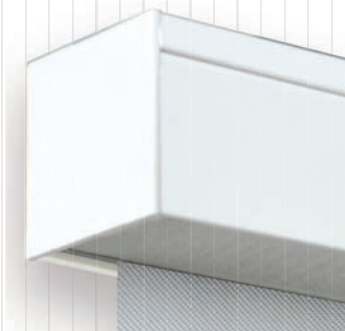

BOX BIG 89S

BOX

230 V

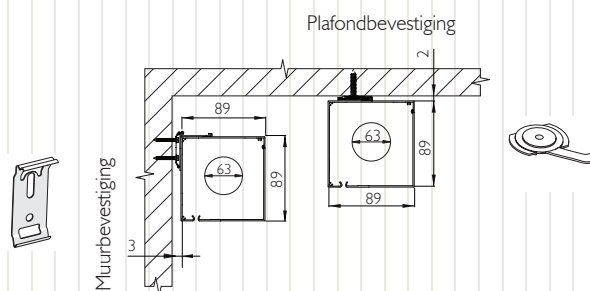
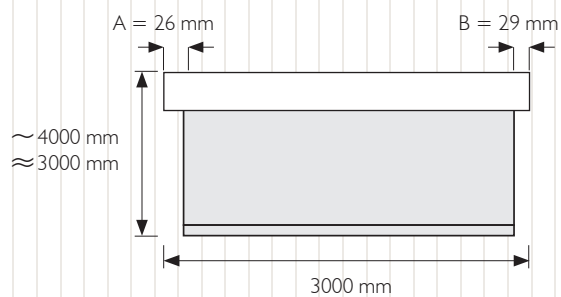
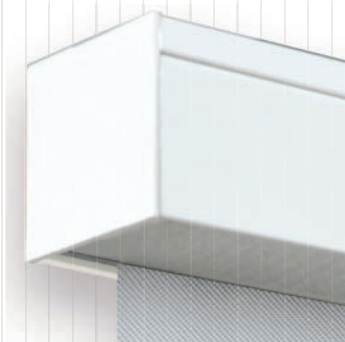

BIG - TECHNISCH OVERZICHT

b & m

~ Lichte stof
≈ Zware stof

De categorie waarin de stoffen worden ingedeeld kan u in de prijslijst terugvinden.

BOX BOX BIG 89S

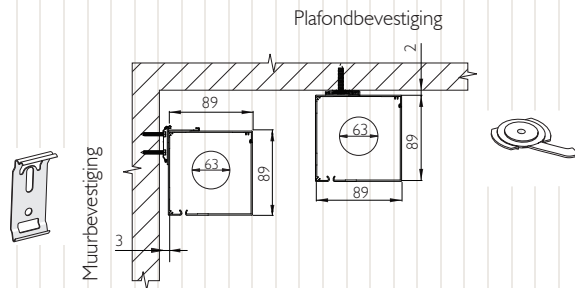
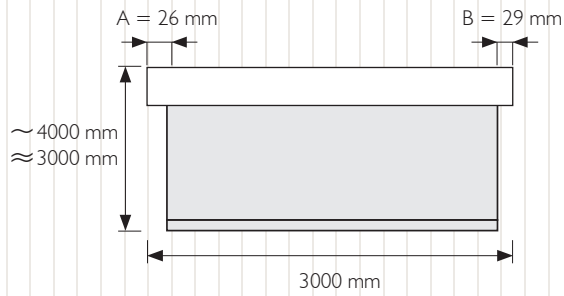
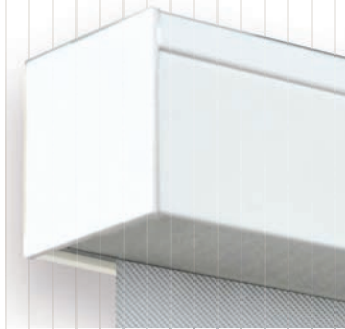

BOX BOX BIG 103S

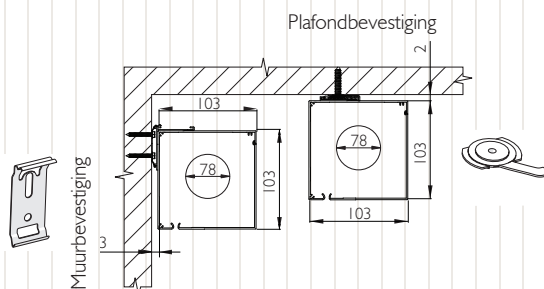
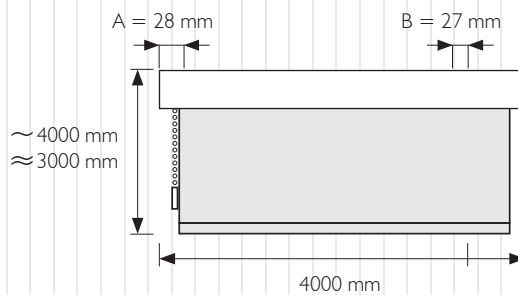

BIG - TECHNISCH OVERZICHT

BOX BOX BIG 103S

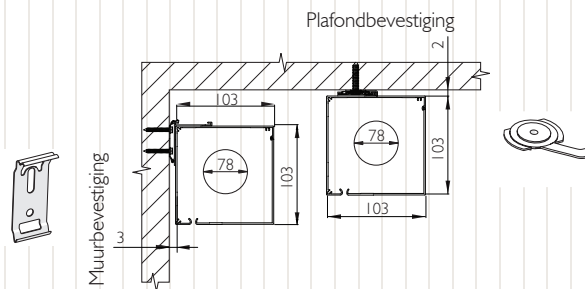
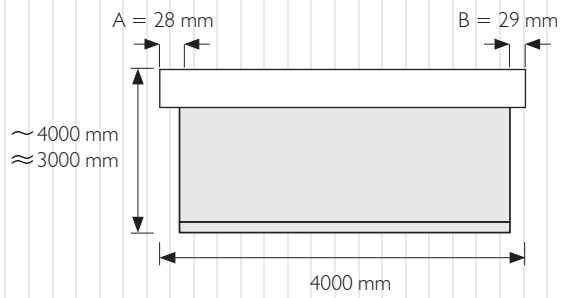
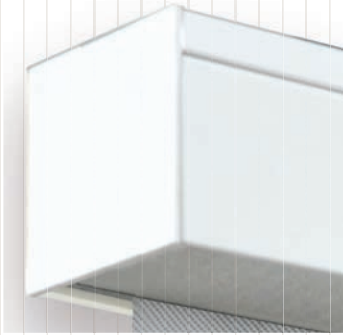

BOX BOX BIG 103S

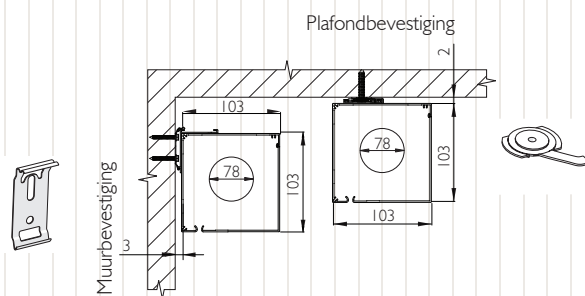
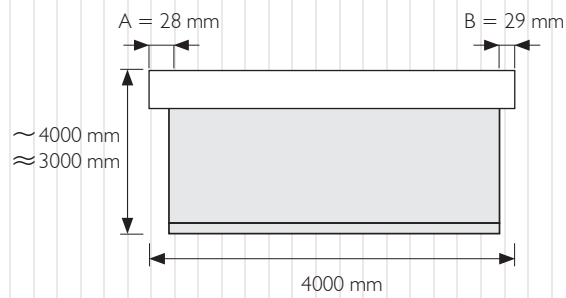

BIG - TECHNISCH OVERZICHT

b & m

~ Lichte stof
≈ Zware stof

De categorie waarin de stoffen worden ingedeeld kan u in de prijslijst terugvinden.

BOX BOX BIG 103S

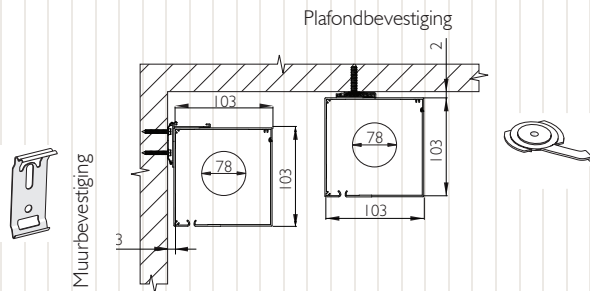
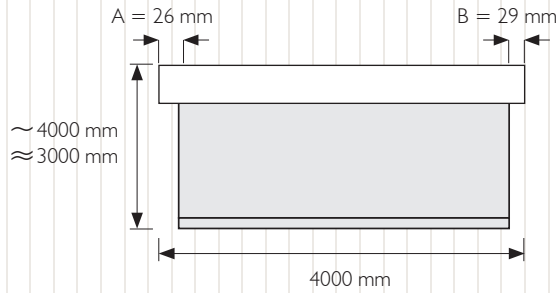
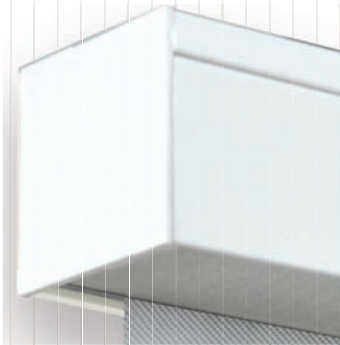

BOX BOX BIG 103S

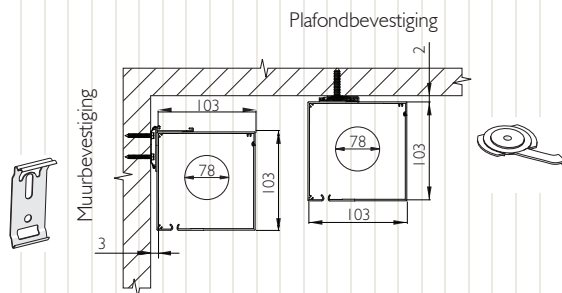
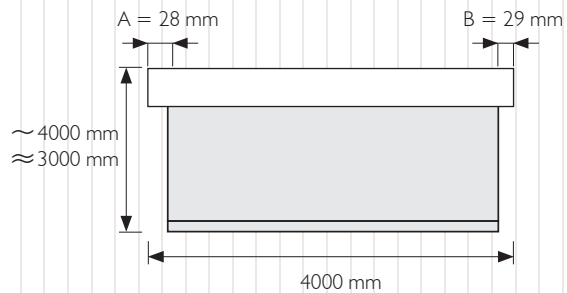

BIG - TECHNISCH OVERZICHT



BIG N DARK 89S



-BX.. 01 02 04 67 RAL

Maximum afmetingen (mm)	Breedte	2500	
	Hoogte, dunne / dikke stof	3000	2400

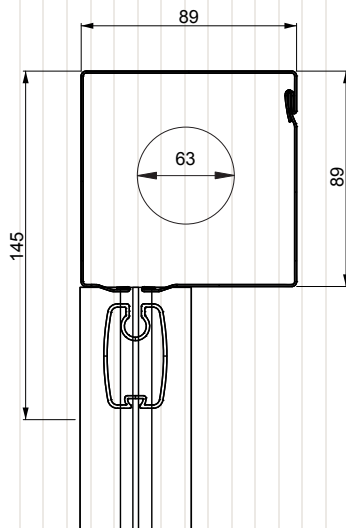

Afmetingen en bevestiging

Muurbevestiging

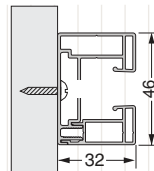

Muurbevestiging

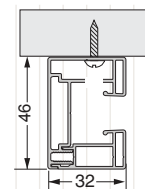

Kabelmogelijkheden

Achterkant

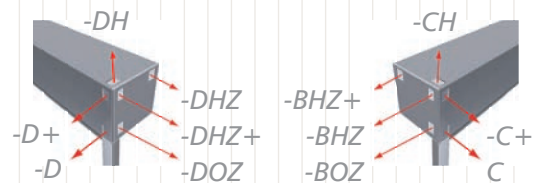

Hoogte van de zijlijding

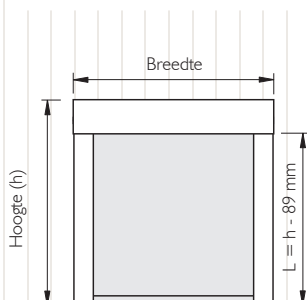

Afmetingen van de onderlat

Lower bar X-BLOCK

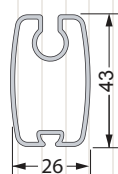

BIG - TECHNISCH OVERZICHT



~ Lichte stof
 ≈ Zware stof

De categorie waarin de stoffen worden ingedeeld kan u in de prijslijst terugvinden.

BIG N DARK 103S



Maximum afmetingen (mm)	Breedte	4000	
	Hoogte, dunne / dikke stof	3000	2500



Afmetingen en bevestiging

Muurbevestiging

Plafondbevestiging

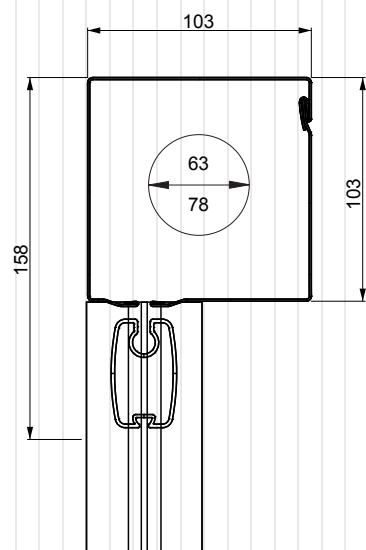
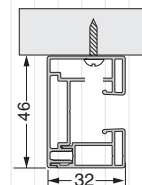
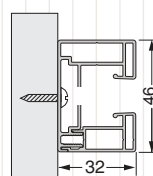

Kabeluitgang

Achterkant

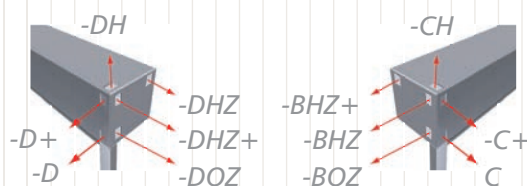

Hoogte van de zijgeleiding

Afmeting van de onderlat

Lower bar X-BLOCK

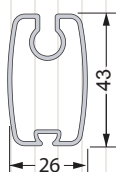
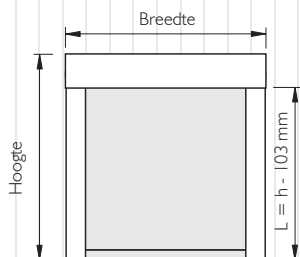



DUO

b & m



4.DUO

4.1 ALGEMENE INFO

25 CM LENGTE



220 CM LENGTE

BESCHIKBAAR IN BUIS MET DIAMETER 40, 43 EN 47 MM

HOU STEEDS REKENING MET DE 1/3 VERHOUDING, ZIE P. 40

STEUNTJES: STANDAARD, HOUT, CASSETTESYSTEEM

BOX ROUND: 68/86

BOX SQUARE: 86

BOX 68 TOT 220 CM

ZONDER BOX TOT 220 CM

MOTOR ENKEL VANAF DIAMETER 40 MM

MOTOR 230 V VOOR GROTERE DIAMETERS

4.2 STEUNTJES

4.2.1 STEUNTJES STANDAARD

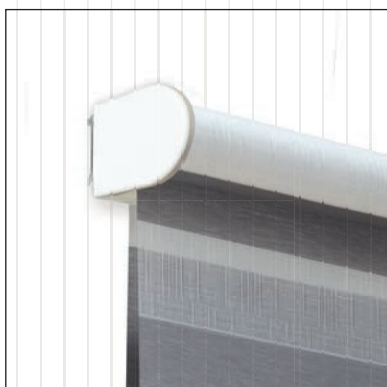

SMALL

Steuntje: 40 mm

Buis: 40 mm

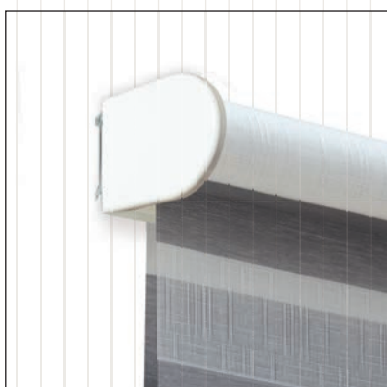
 + any color you want

MEDIUM

Steuntje: 43 mm

Buis: 43 mm

 + any color you want

LARGE

Steuntje: 47 mm

Buis: 47 mm

 + any color you want

4.2.2 STEUNTJES HOUT

De houten steuntjes zijn beschikbaar in rechte en ronde afwerking.

SMALL

Afmetingen: buis 40 mm

5 standaardkleuren voor steuntjes,
any color you want mogelijk mits meerprijs.

MEDIUM/LARGE

Afmetingen: buis 47 mm

5 standaardkleuren voor steuntjes,
any color you want mogelijk mits meerprijs.



* De houten bovenlat is beschikbaar voor alle REN-systemen zonder box.



4.2.4 MONTAGEPROFIEL*/**

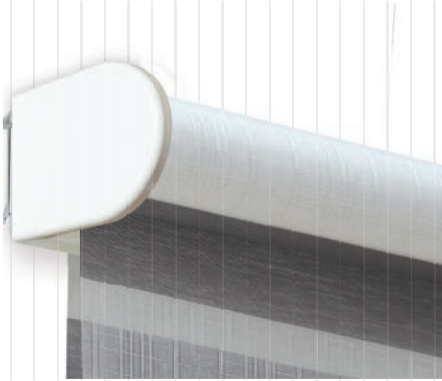

Afmetingen: enkel bij buisdiameter 40 en 47 mm.

4.2.5 KOVEN/BOX



HALF-OPEN BOX ROUND

Afmetingen: box 68 tot 220 cm lengte.



GESLOTEN BOX ROUND

Afmetingen: box 86 tot 220 cm lengte.

* Voor de afmetingen verwijzen we graag naar de technische tekeningen.

** Maximale breedte is steeds afhankelijk van de gekozen stof en de systeemhoogte.

DUO

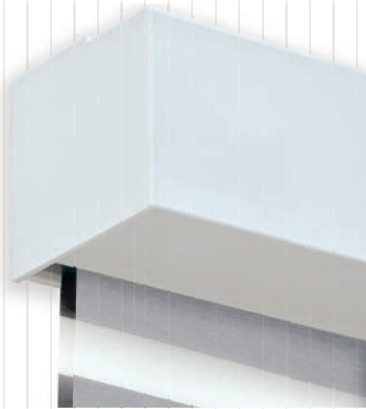

GESLOTEN BOX SQUARE

Afmetingen: box 86 tot 220 cm lengte.

4.2.7 UITLIJNEN VAN DE STREPEN

In de laagste positie is de DUO verduisterend doordat de strepen elkaar overlappen.

DUO gordijnen met verschillende hoogtes zijn moeilijk om uit te lijnen.

De strepen kunnen uitgelijnd worden bij een verlenging of verkorting van een van de gordijnen (max. 80 mm, de hoogte van een streep) met een tolerantie van ongeveer 5 mm.

! Specifieer bij de bestelling *altijd* hoe de DUO uitgelijnd moet worden, ook al zijn ze dezelfde hoogte!

Geef aan welk DUO de 'master' is en welke DUO daaraan aangepast moet worden.

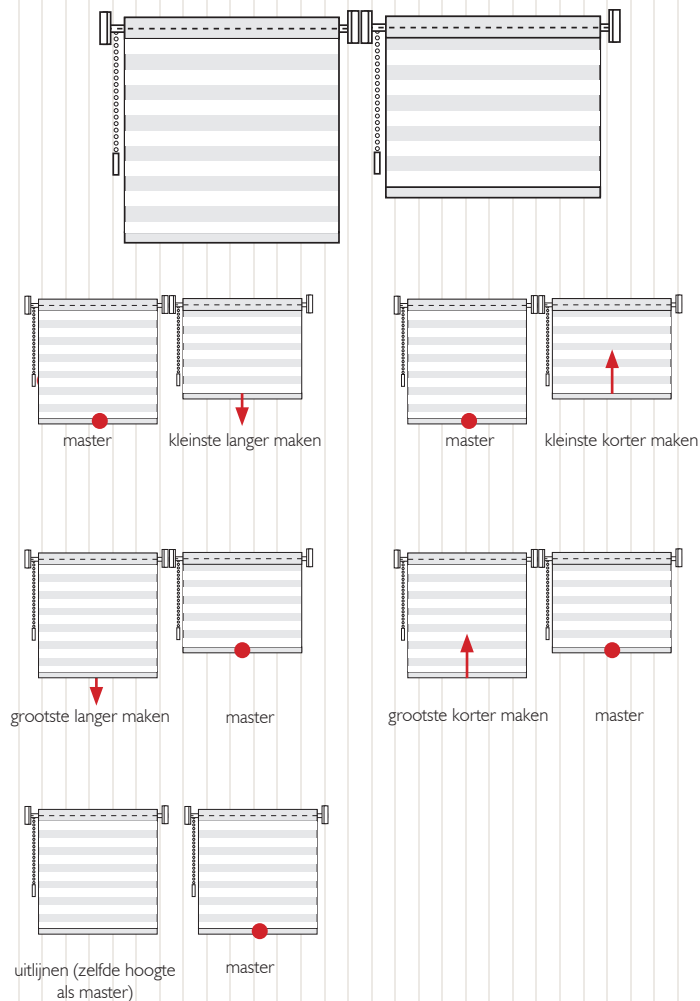

In de ● positie overlappen de strepen elkaar

4.3 BEDIENING

4.3.1 MANUELE BEDIENING

KETTINGBEDIEND



Zoals in de basiskeuzes besproken, kan je de keuze maken om het systeem manueel te bedienen.

Dit is steeds met een ketting, waarmee je het systeem op- en neerlaat.

4.3.2 ELEKTRISCHE BEDIENING

OP BATTERIJ 12 V - enkel bij buisdiameter 40 mm



Bmfabrics-batterij = interne batterij - komt standaard met oplaadbare batterij

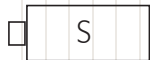

Somfy-batterij = externe batterij - oplaadbare of niet oplaadbare batterijen

Lengte van de batterij: 8 stuks = 45 centimeter , 10 stuks = 55 centimeter

BEDRADE SYSTEMEN

Voeding	Bediening
<p>230 V A</p> <p>Bm-motor</p>	<ul style="list-style-type: none"> - Draadloze BM-afstandsbediening - Schakelaar/domotica
<p>230 V S</p> <p>Somfy-motor</p>	<ul style="list-style-type: none"> - Telis- & Modulis-afstandsbediening - Schakelaar/domotica

Al onze elektrische systemen hebben een stille motor.

DRAADLOZE BEDIENING

Het systeem kan draadloos bediend worden door de afstandbediening van Bmfabrics of van Somfy. Voor 12 V- en 230 V-systemen: vraag naar onze andere opties.



BM-standaard
1 of meerdere kanalen



Somfy Telis
1 kanaal



Somfy Modulis
1 of meerdere kanalen



Somfy-schakelaar
1 kanaal

4.3.3 GROEPEREN*

Het groeperen van meerdere DUO's kan enkel bij types 86R en 86S.

EEN BEDIENING PER SYSTEEM

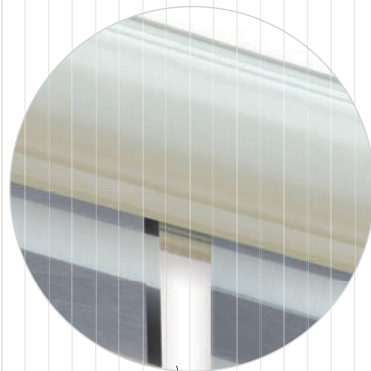

- Om 2 of 3 systemen te groeperen
- 1 aandrijving voor alle gegroepeerde systemen
- Het op- en neergaan van de rolgordijnen gebeurt tegelijk
- Max. 3 systemen aansluiten op 1 motor

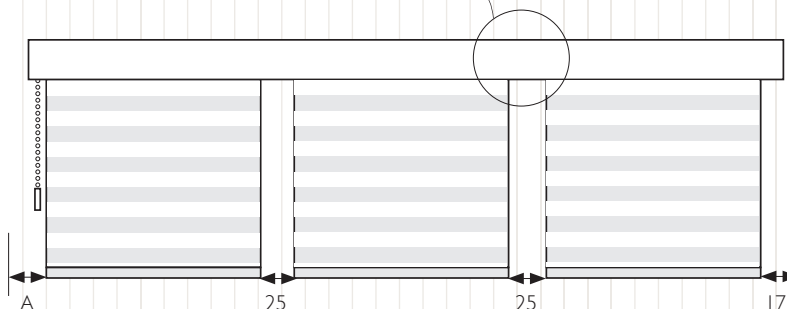

A = afhankelijk van het type van systeem

* Opgelet: om meerdere motorische systemen te koppelen en met één bediening aan te sturen, dient men altijd een relais te gebruiken.

INDIVIDUELE BEDIENING

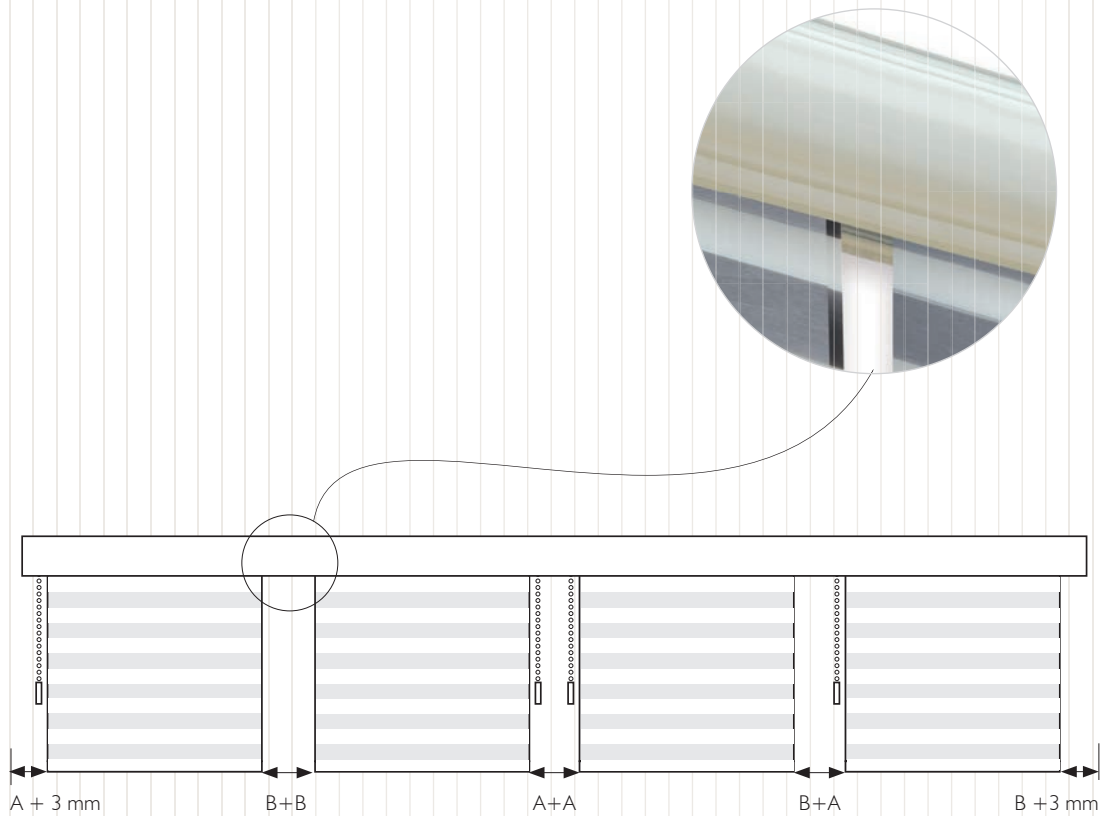

A = afhankelijk van
het type van systeem

B = afhankelijk van
het type van systeem

- Om 2 of 3 systemen te groeperen
- 1 aandrijving per gordijn
- Het op- en neergaan van de rolgordijnen gebeurt individueel

4.4 OPMETEN

Spannende breedte - gewilde speling: wij raden een minimum van 1 cm aan.

! Zorgenvrij: we hebben ook een plaatsingsdienst.

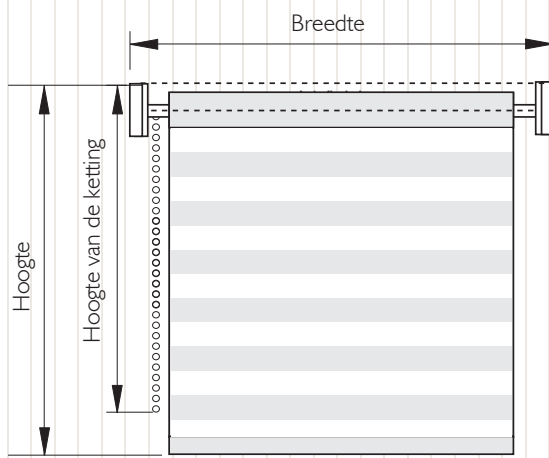

Muurbevestiging

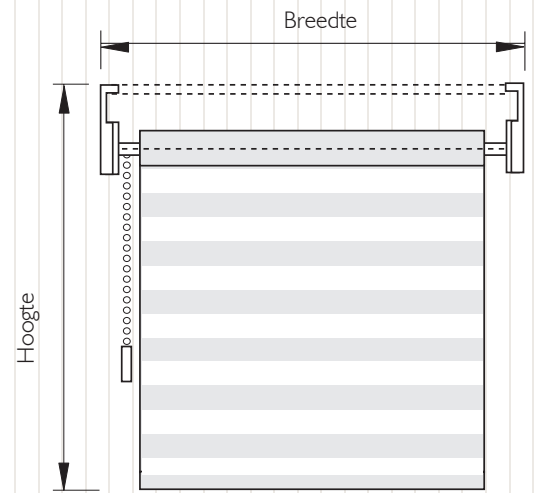

Plafondbevestiging

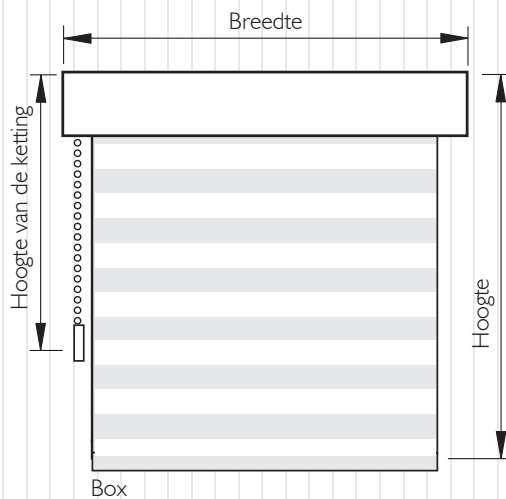

Box

!

Indien de breedte van het systeem $1/3$ smaller is dan de hoogte, kunnen we geen perfecte werking garanderen.

Als de bevestigingskeuze niet gespecificeerd is, kiest Bmfabrics standaard muurbevestiging.

We reduceren de maximum breedte met 20-30 cm voor zware stoffen en stoffen die krimpen.

4.5 TECHNISCH OVERZICHT



DUO 40

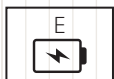
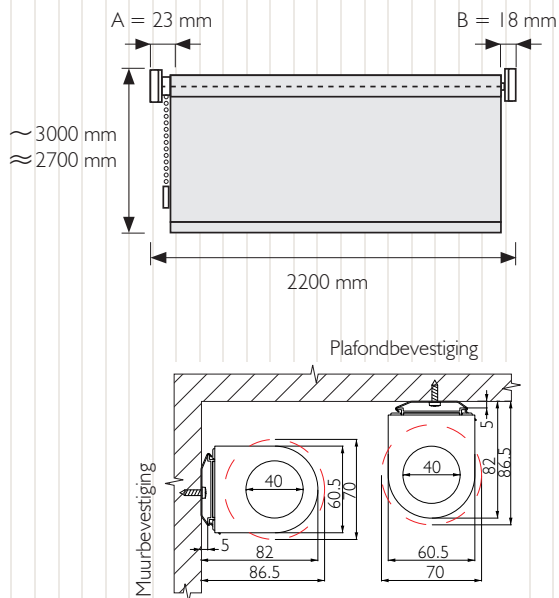
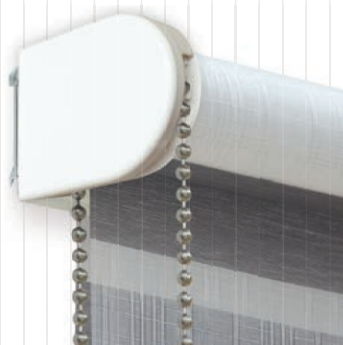

DUO 40

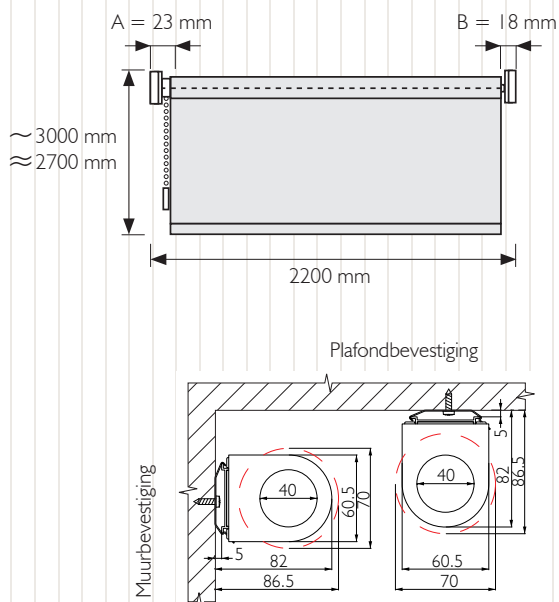

DUO - TECHNISCH OVERZICHT

b & m

~ Lichte stof
≈ Zware stof

De categorie waarin de stoffen worden ingedeeld kan u in de prijslijst terugvinden.



DUO 40

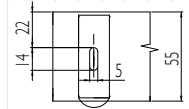
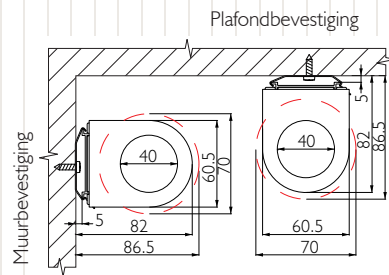
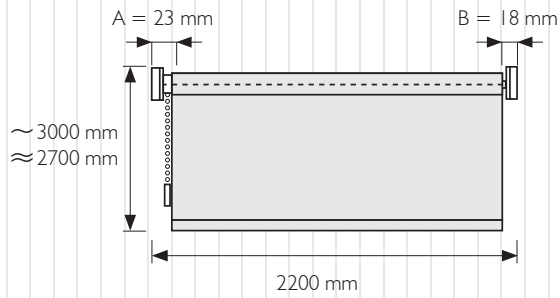
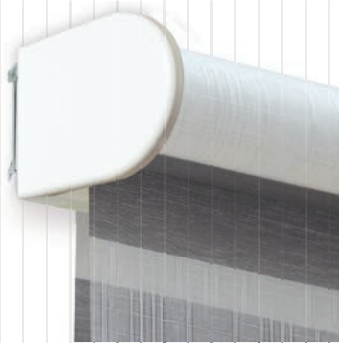
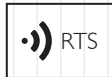

DUO - TECHNISCH OVERZICHT



DUO 47

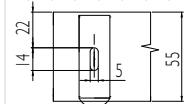
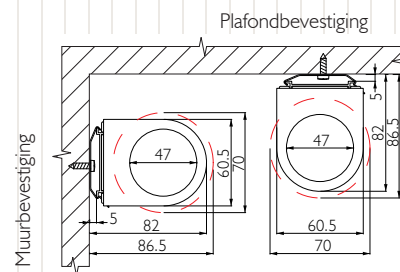
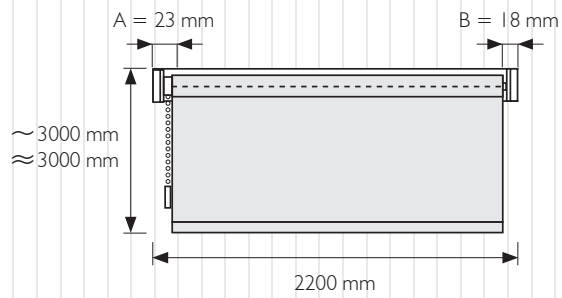
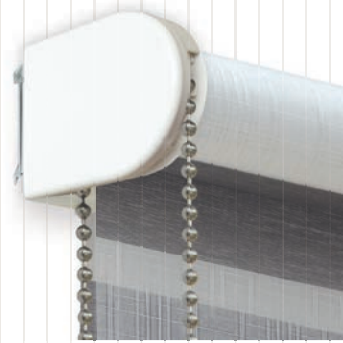

DUO 47

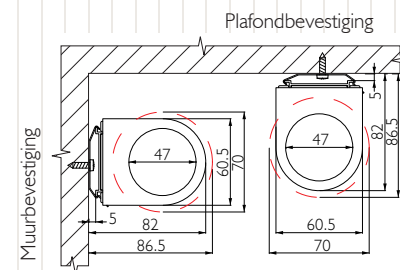
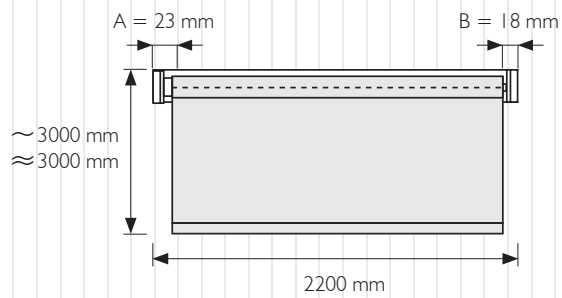
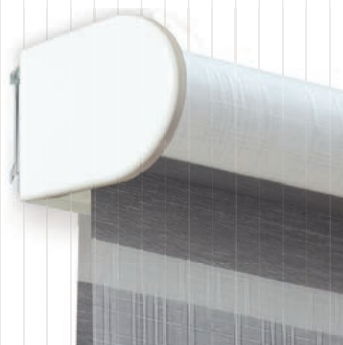

DUO - TECHNISCH OVERZICHT

b & m

~ Lichte stof
 ≈ Zware stof

De categorie waarin de stoffen worden ingedeeld kan u in de prijslijst terugvinden.

·) RTA **DUO 47**

⏻ A 230V

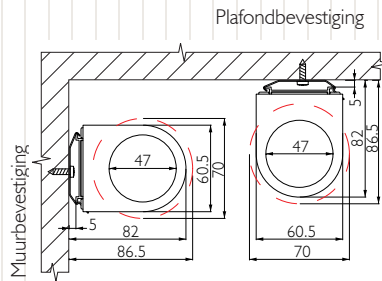
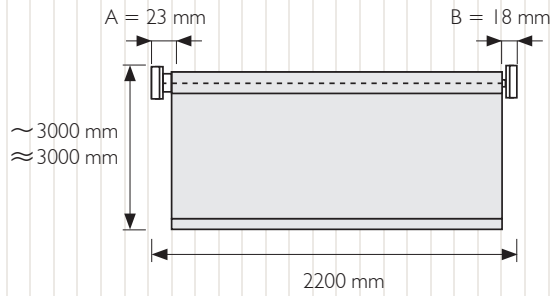
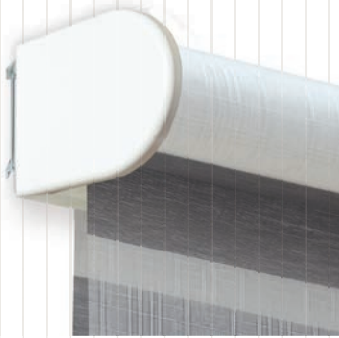

⏻ S 230V **DUO 47**

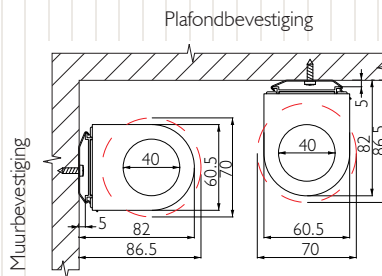
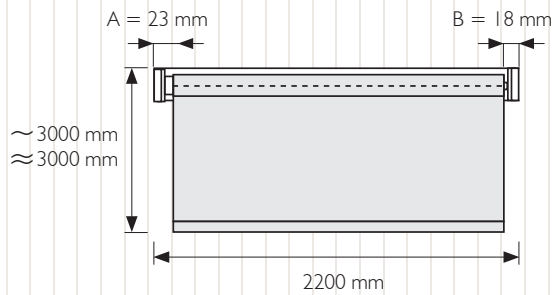
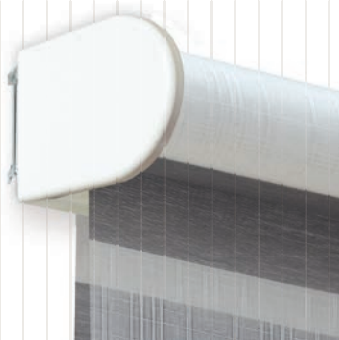

DUO - TECHNISCH OVERZICHT



DUO 47

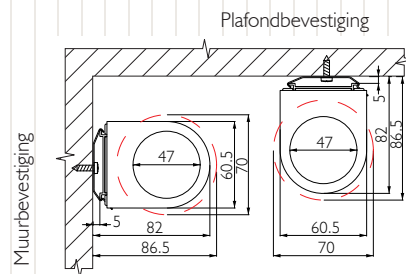
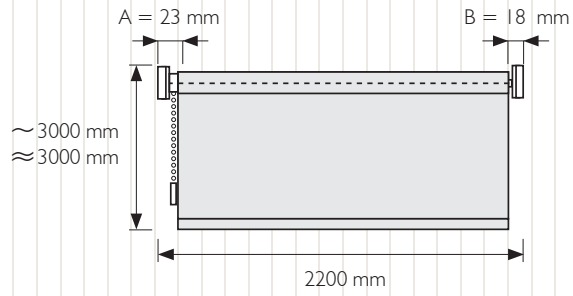
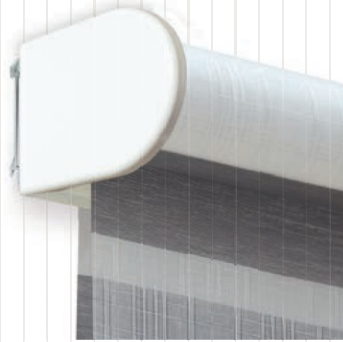

DUO 47

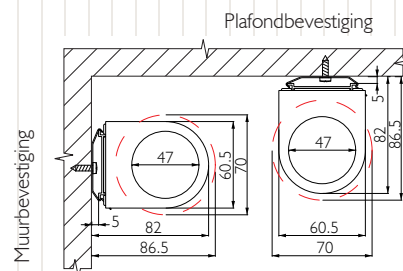
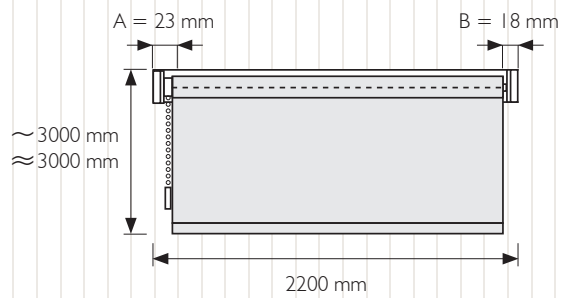

DUO - TECHNISCH OVERZICHT

~ Lichte stof
 ≈ Zware stof

De categorie waarin de stoffen worden ingedeeld kan u in de prijslijst terugvinden.

b & m

BOX DUO 68R

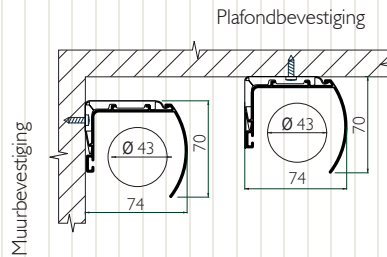
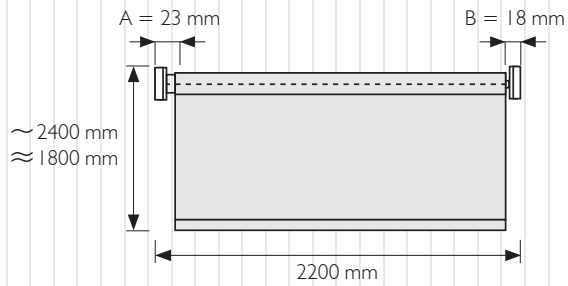

BOX DUO 68R

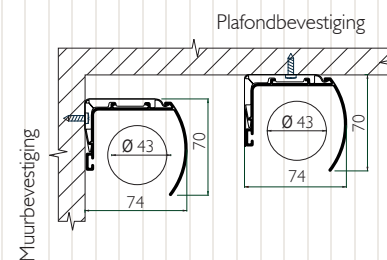
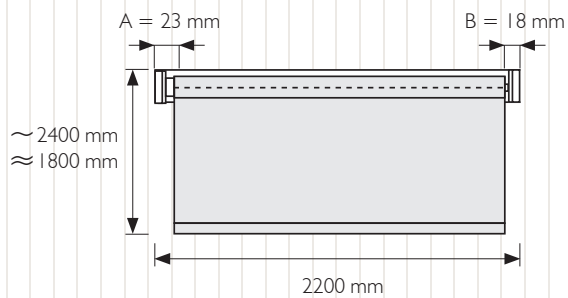
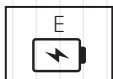

DUO - TECHNISCH OVERZICHT

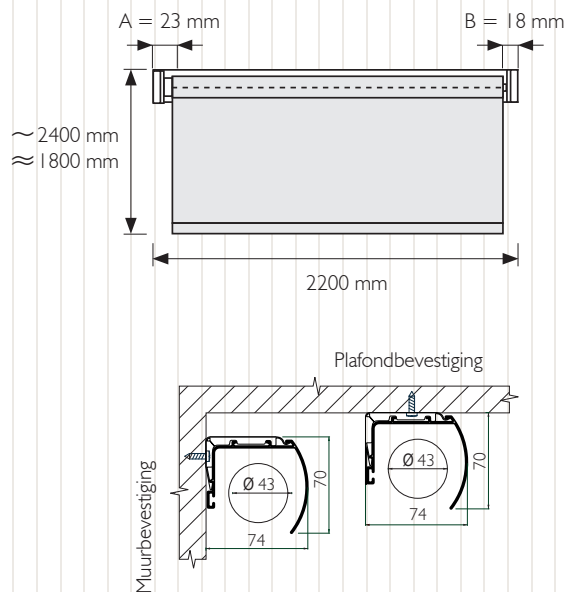
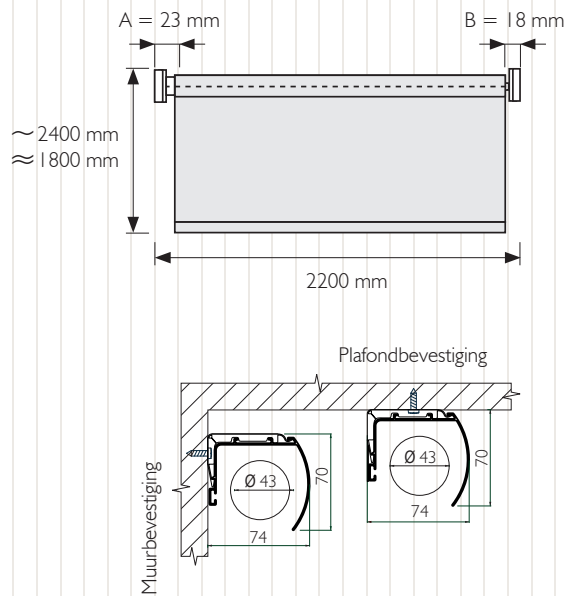
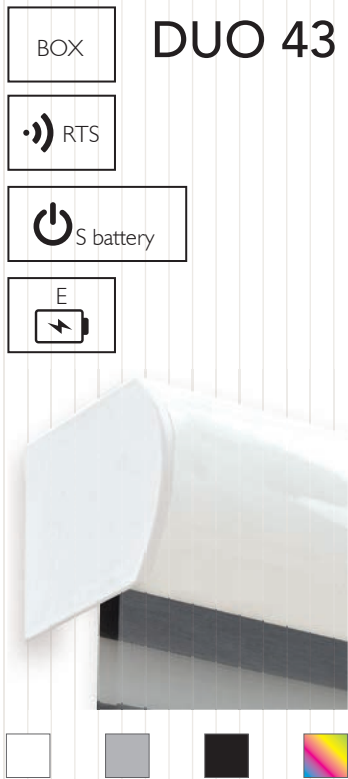

DUO - TECHNISCH OVERZICHT

b & m

~ Lichte stof
 ≈ Zware stof

De categorie waarin de stoffen worden ingedeeld kan u in de prijslijst terugvinden.

BOX **DUO 68R**

·) RTA

⏻ A 230V

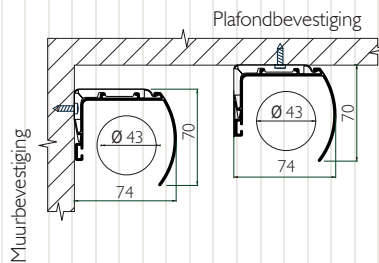
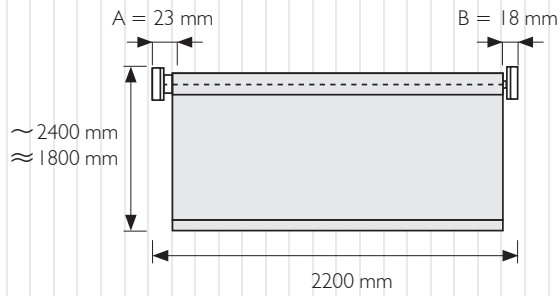

BOX **DUO 68R**

⏻ S battery

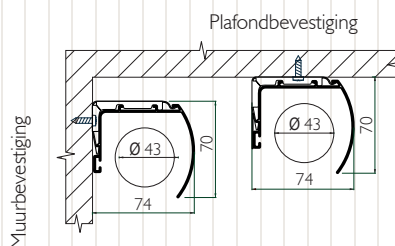
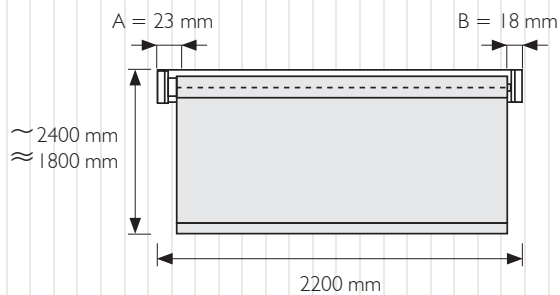

DUO - TECHNISCH OVERZICHT

BOX **DUO 68R**

RTS

S 230V

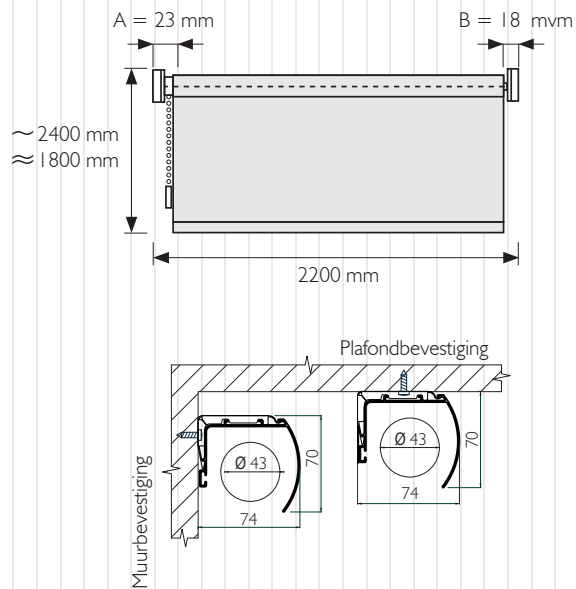

BOX **DUO 68R**

RTD

D 230V

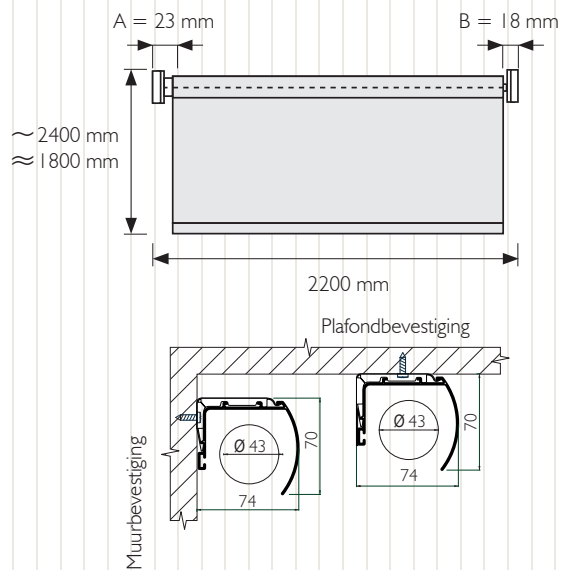

DUO - TECHNISCH OVERZICHT

b & m

~ Lichte stof
 ≈ Zware stof

De categorie waarin de stoffen worden ingedeeld kan u in de prijslijst terugvinden.

BOX DUO 86R

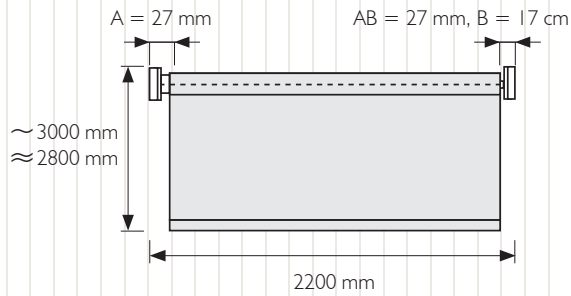

ASP = 25 mm

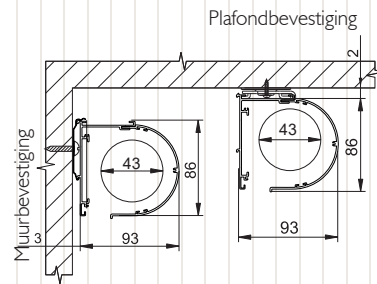
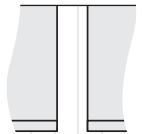

BOX DUO 86R

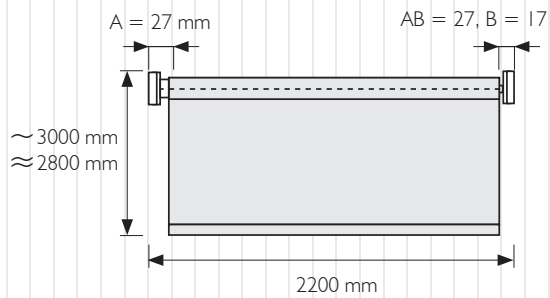
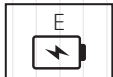

ASP = 25 mm

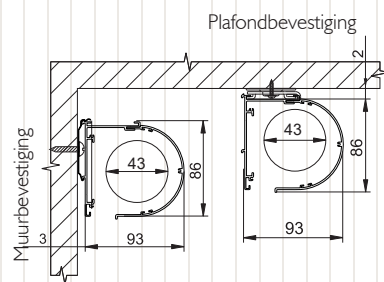

DUO - TECHNISCH OVERZICHT

BOX DUO 86R

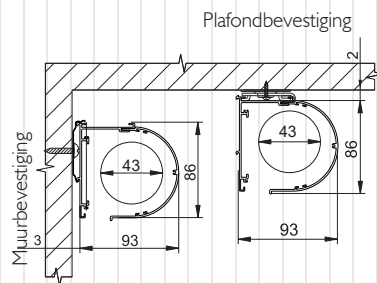
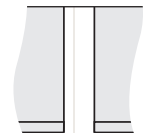
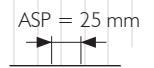
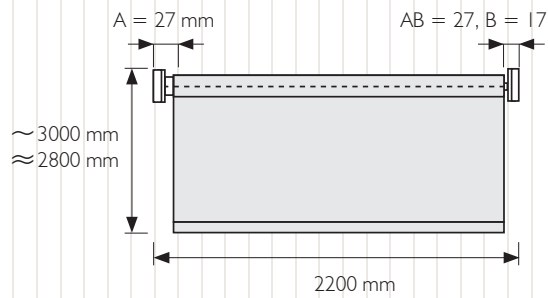
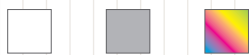
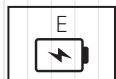

BOX DUO 86R

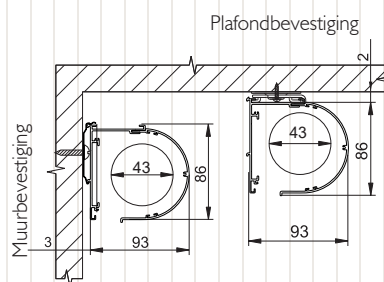
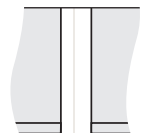
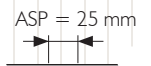
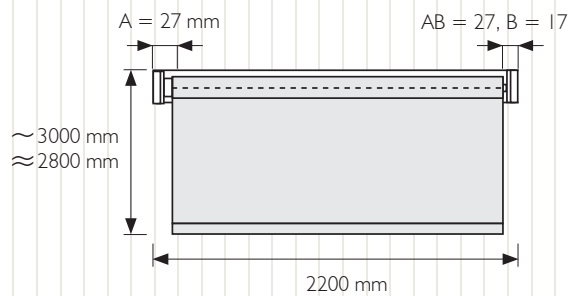
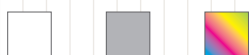

DUO - TECHNISCH OVERZICHT

b & m

~ Lichte stof
 ~ Zware stof

De categorie waarin de stoffen worden ingedeeld kan u in de prijslijst terugvinden.

BOX **DUO 86R**

⏻ A 230V

📡 RTA

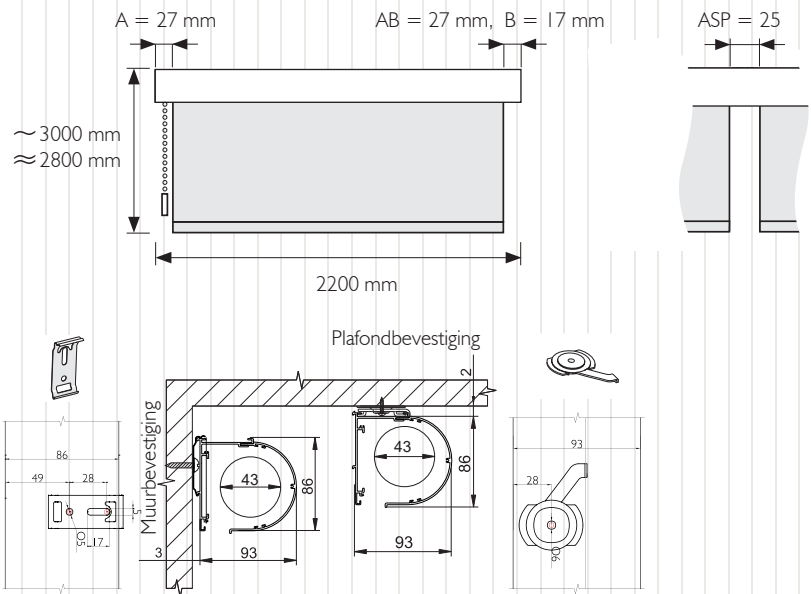
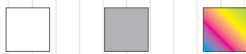

BOX **DUO 86R**

⏻ S 230V

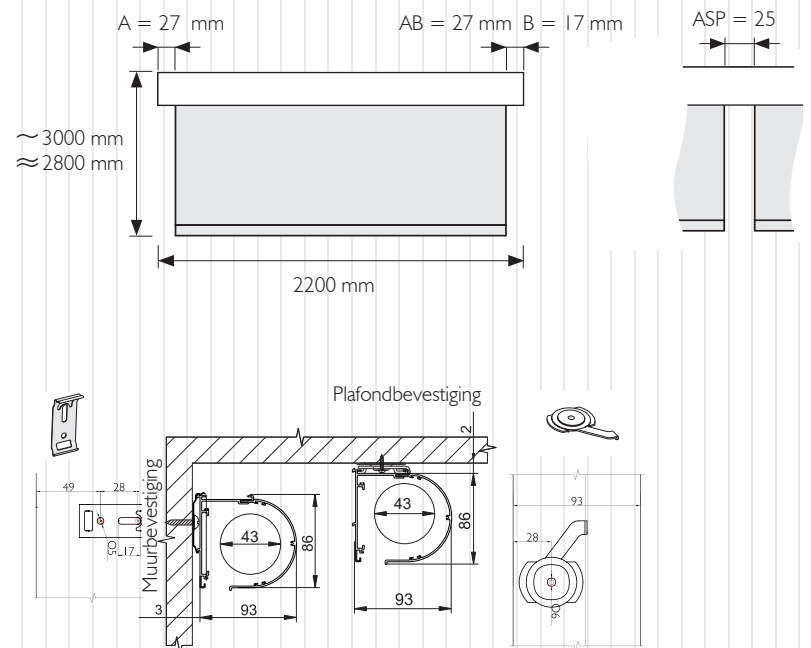

DUO - TECHNISCH OVERZICHT

BOX DUO 86R

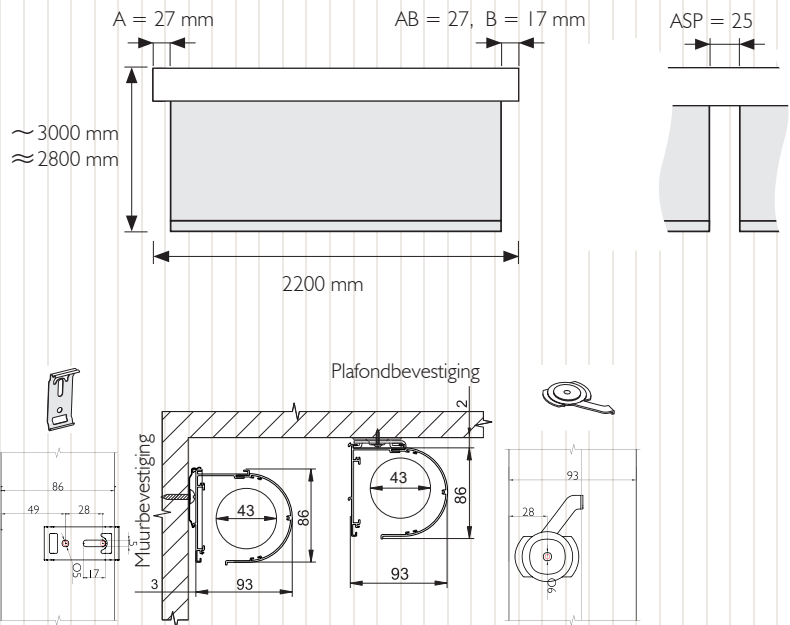
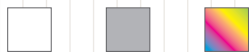

BOX DUO 86R

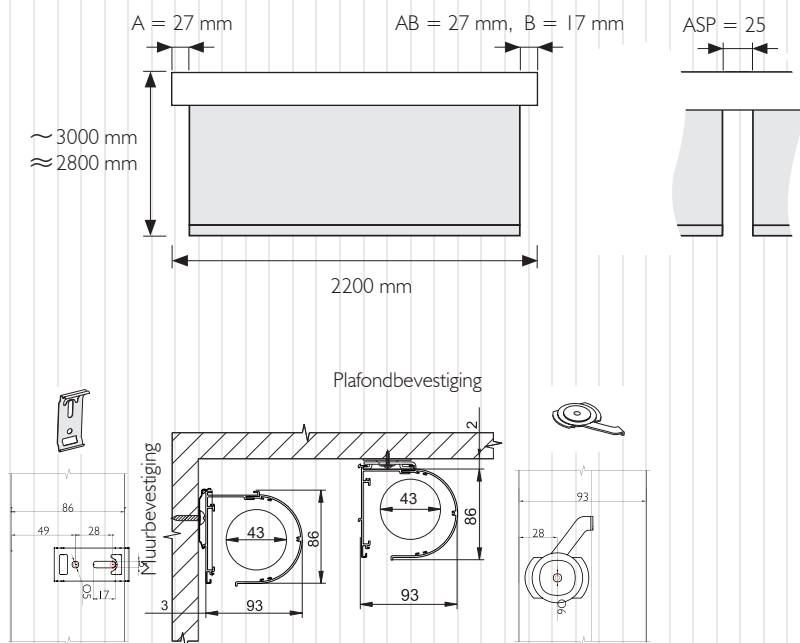
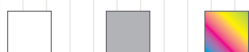

DUO - TECHNISCH OVERZICHT

b & m

~ Lichte stof
 ~ Zware stof

De categorie waarin de stoffen worden ingedeeld kan u in de prijslijst terugvinden.

BOX DUO 86S

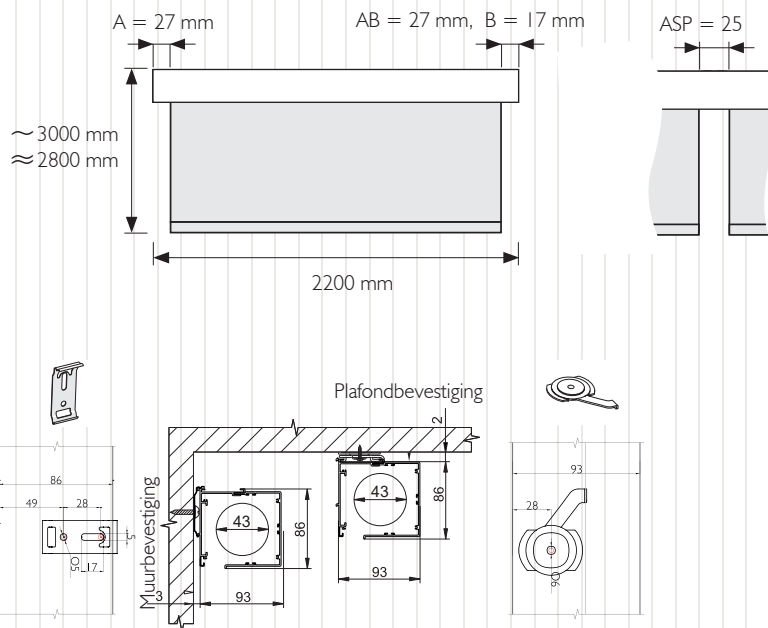

BOX DUO 86S

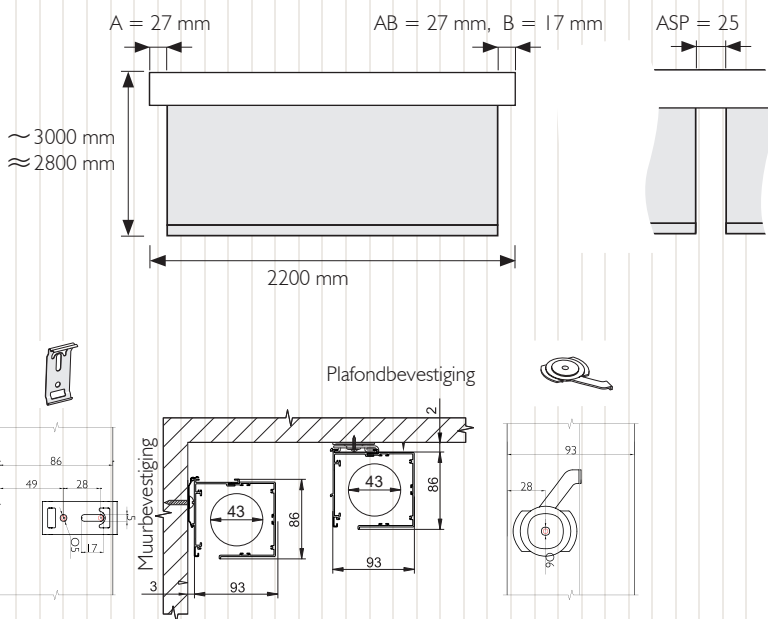
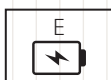

DUO - TECHNISCH OVERZICHT

BOX DUO 86S

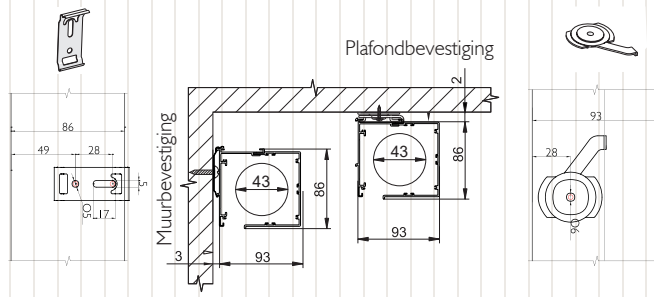
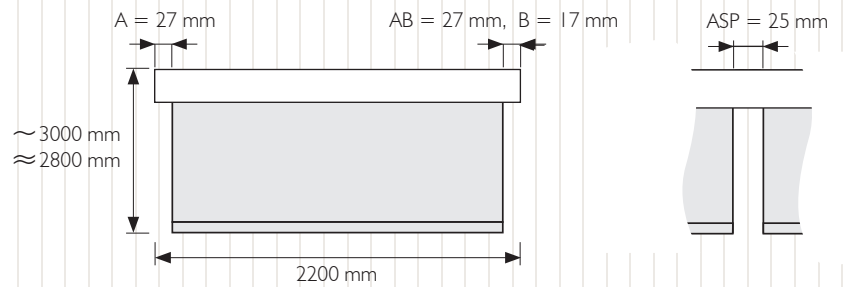
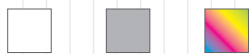
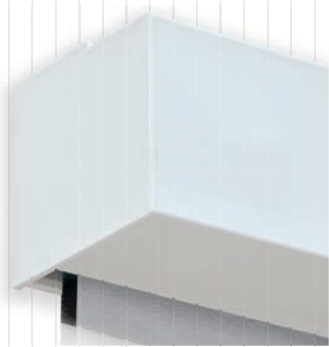
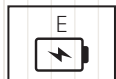

BOX DUO 86S

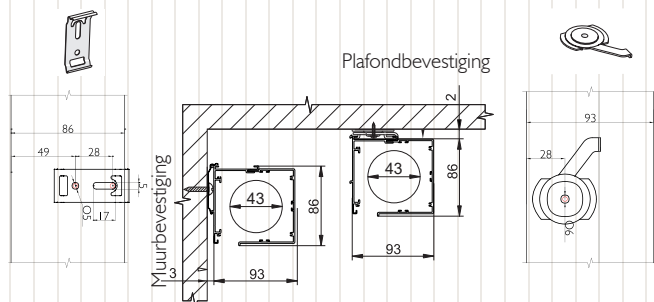
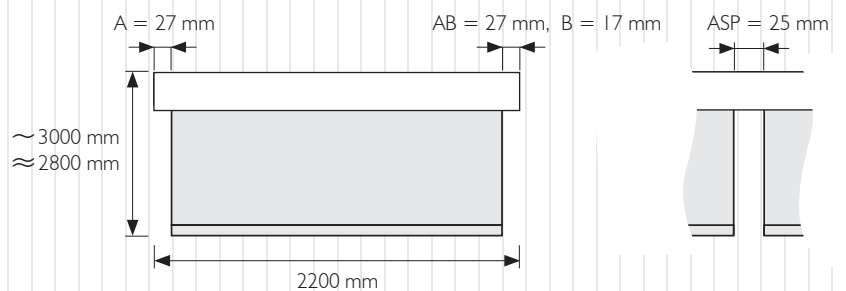
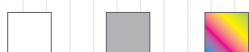

DUO - TECHNISCH OVERZICHT

b & m

~ Lichte stof
 ≈ Zware stof

De categorie waarin de stoffen worden ingedeeld kan u in de prijslijst terugvinden.

BOX **DUO 86S**

RTA

230V

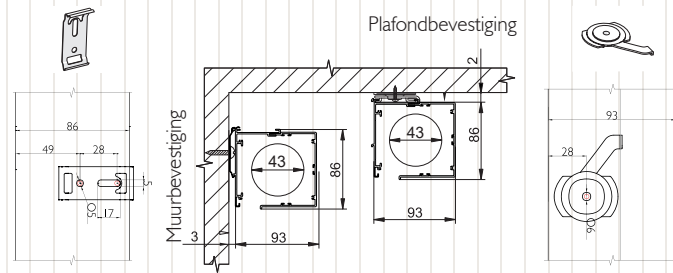
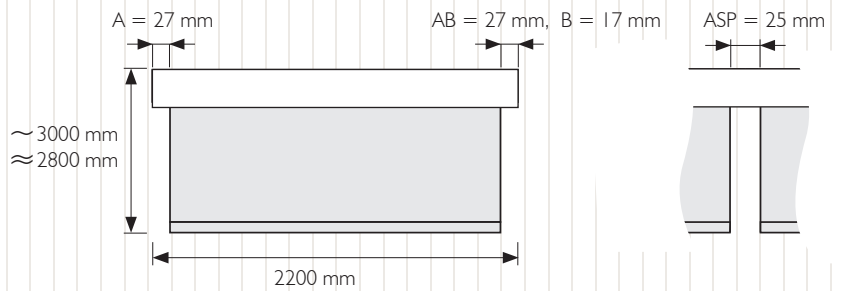

BOX **DUO 86S**

230V

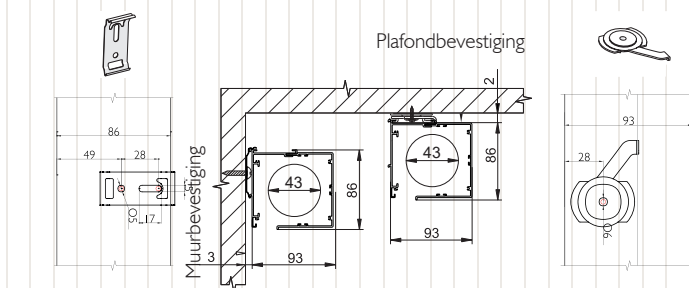
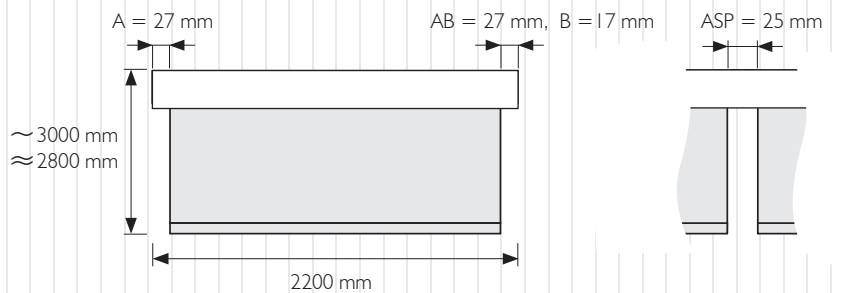
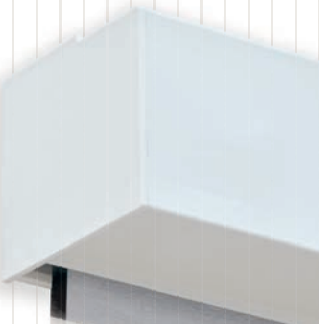

DUO - TECHNISCH OVERZICHT

BOX **DUO 86S**

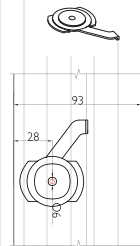
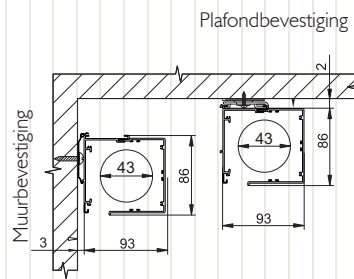
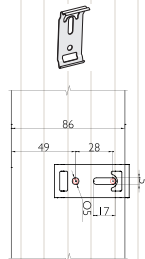
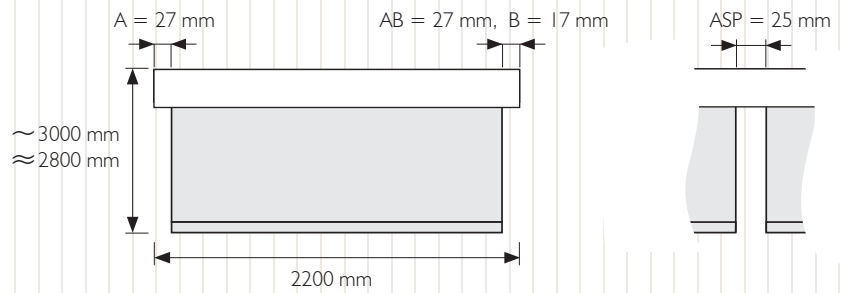



BMFABRICS

Hoogstraat 177
9550 Herzele, België

T +32 (0)53 60 70 60
E info@bmfabrics.com
W www.bmfabrics.com